

# Fairfield Road Active Travel improvement

**Dorchester Markets Informal Joint Panel  
27 September 2023**

**Chris Peck  
Principal Transport Planner**

**Kerry Hall  
Assistant Project Manager**

# Summary

- Public engagement
- Summary of consultation report
- Detailed design – highway scheme
- Draft sketch – public realm element
- Issues arising
- Timescales

# Public engagement on Fairfield Road

- 9/1/2023 – Dorchester Town Council Planning & Environment Committee
- 25/1/2023 – Dorchester Informal Markets Joint Panel
  - Feedback:
    - » move footway to northern side of the road
    - » make sure access onto Maumbury Road is improved
    - » look at Upper Fairfield Road safety
- Online consultation ran from 16/2/23 – 17/3/23
- 14/3/23 - Meeting with Dorchester Access Group
- May 2023 – Consultation Report published
- June 2023 – Further update provided to Dorchester Town Council
- September 2023 – Planning Application underway

# Public consultation questions

Respondents asked to what they agreed with the following elements:

- A dedicated footway along Fairfield Road
- A way to access the car park directly from the railway station (Copper Street)
- Safer crossing points across Fairfield Road at junctions
- Restricting vehicle access to Fairfield Road (Weymouth Avenue)
- Benches, planters and habitat improvements on Fairfield Road
- Better street lighting on Fairfield Road

# Who responded

Tell us who you are

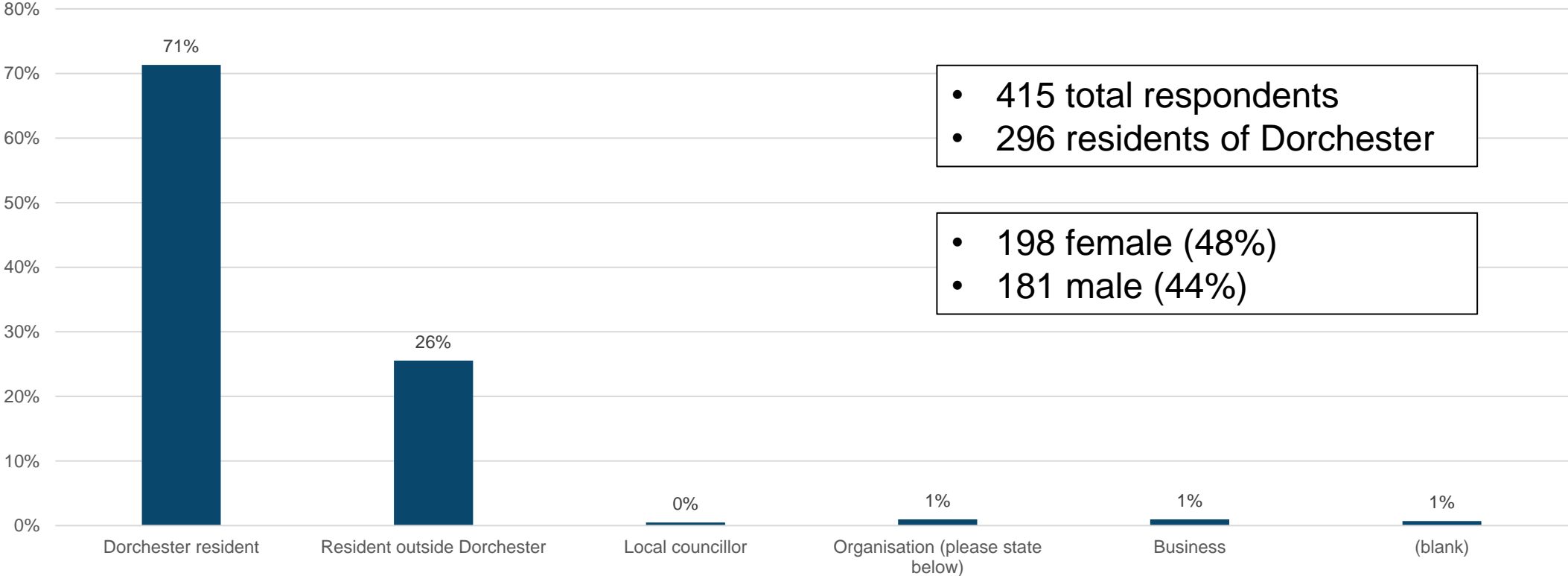

- 415 total respondents
- 296 residents of Dorchester

- 198 female (48%)
- 181 male (44%)

# Who responded: age

Which age group do you belong to?

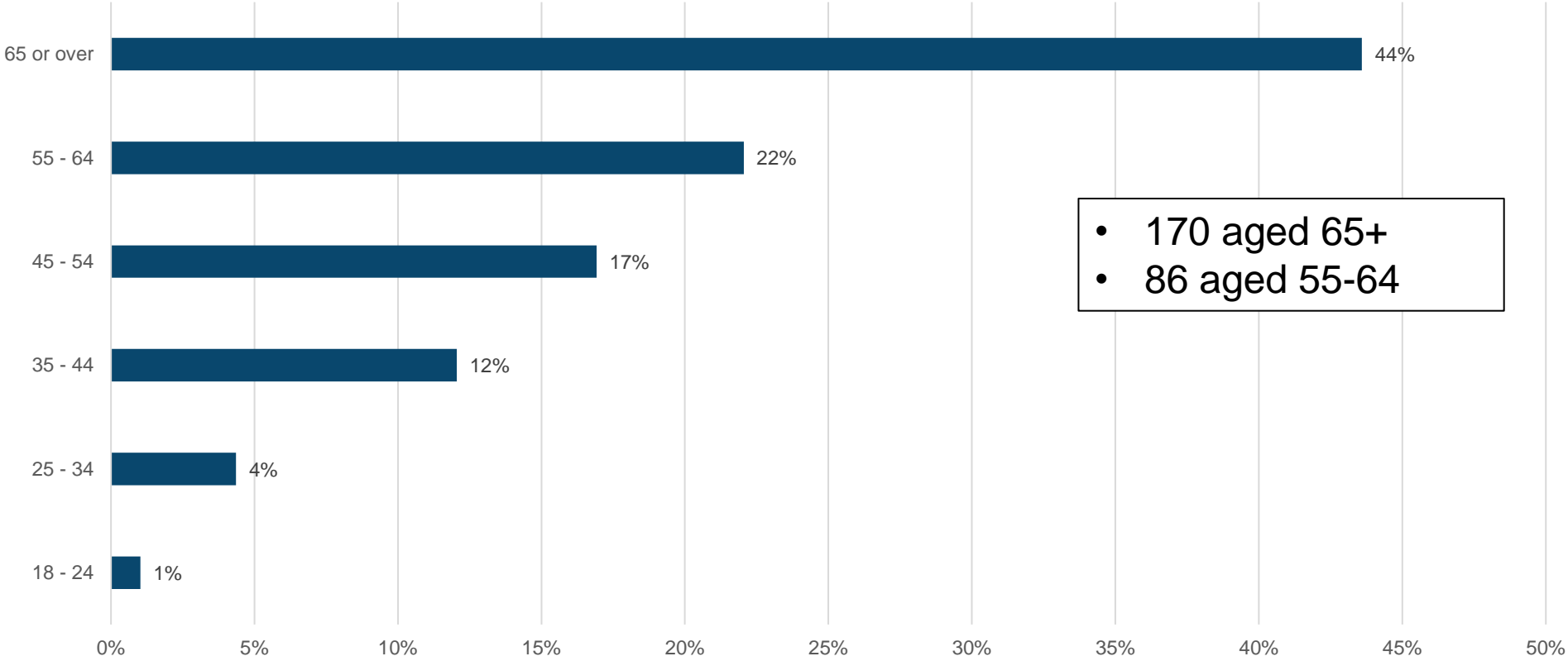

# Who responded: disabled people

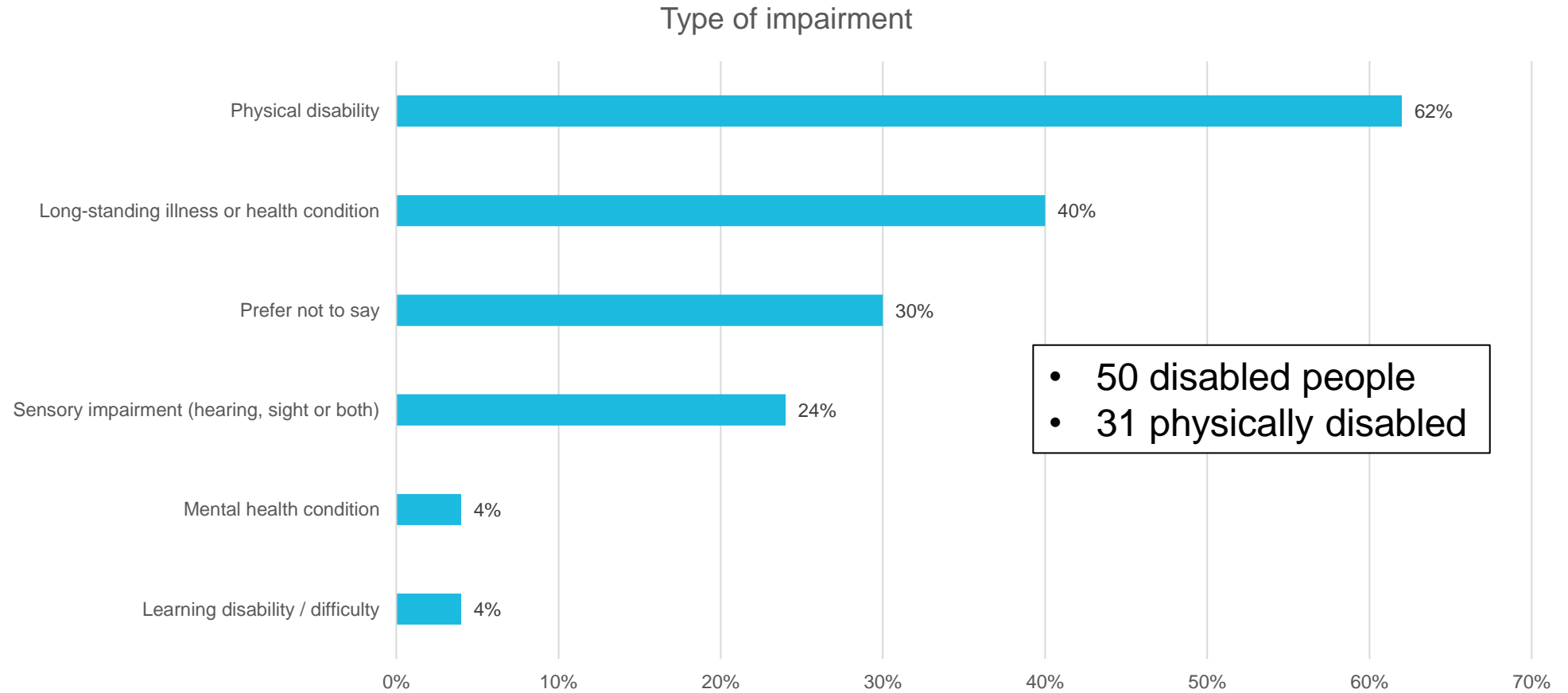

# How people use Fairfield Road now

How do you travel on Fairfield Road at the moment?

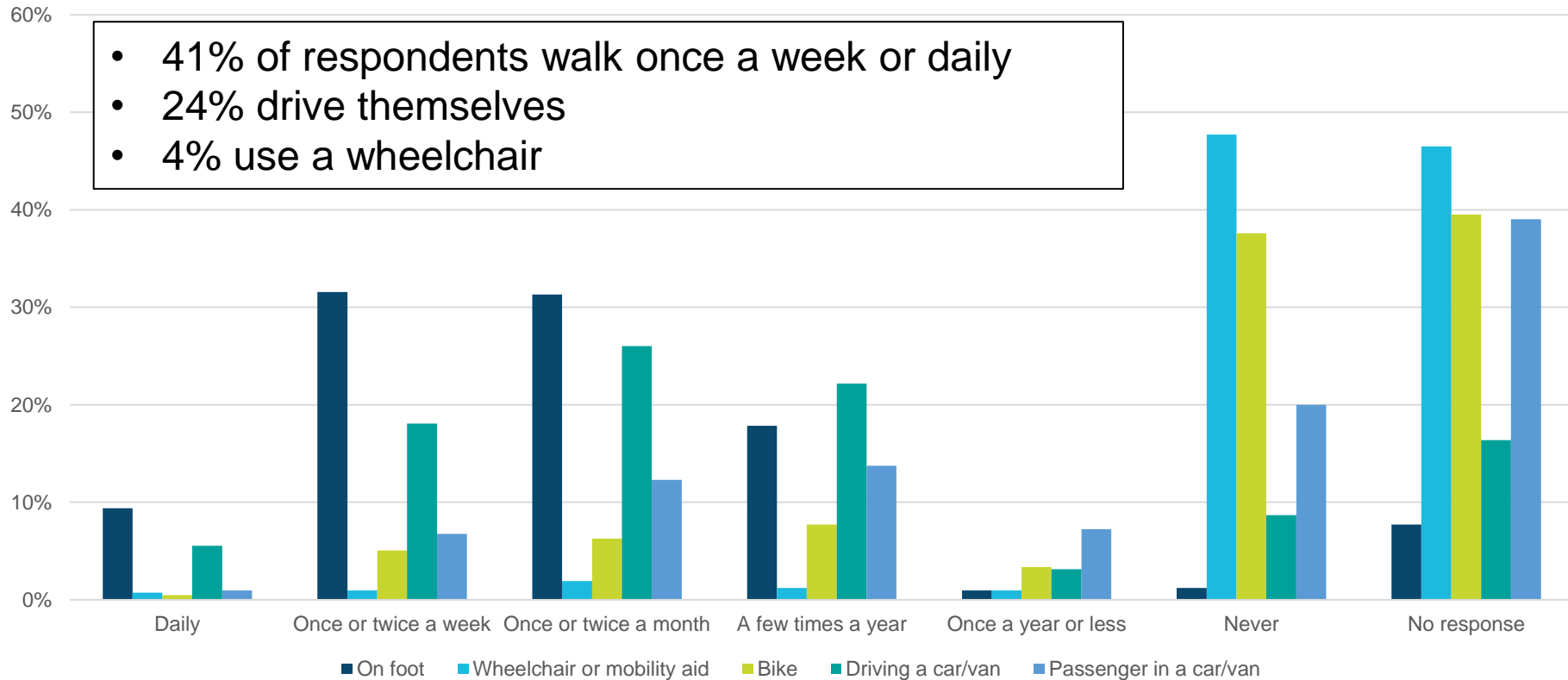



# How people use Fairfield Road now

When you use Fairfield Road, what are you doing?

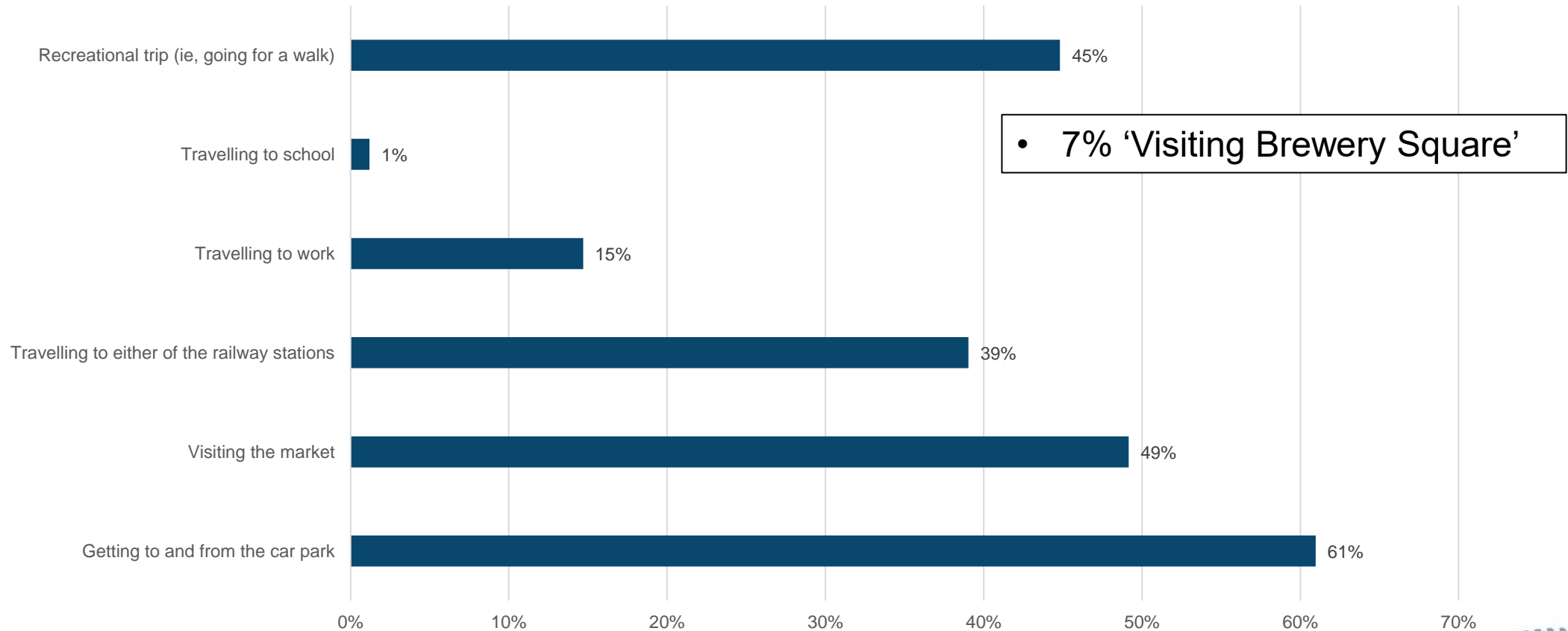

# Agreement with scheme elements

How do you feel about the individual aspects of the proposal?

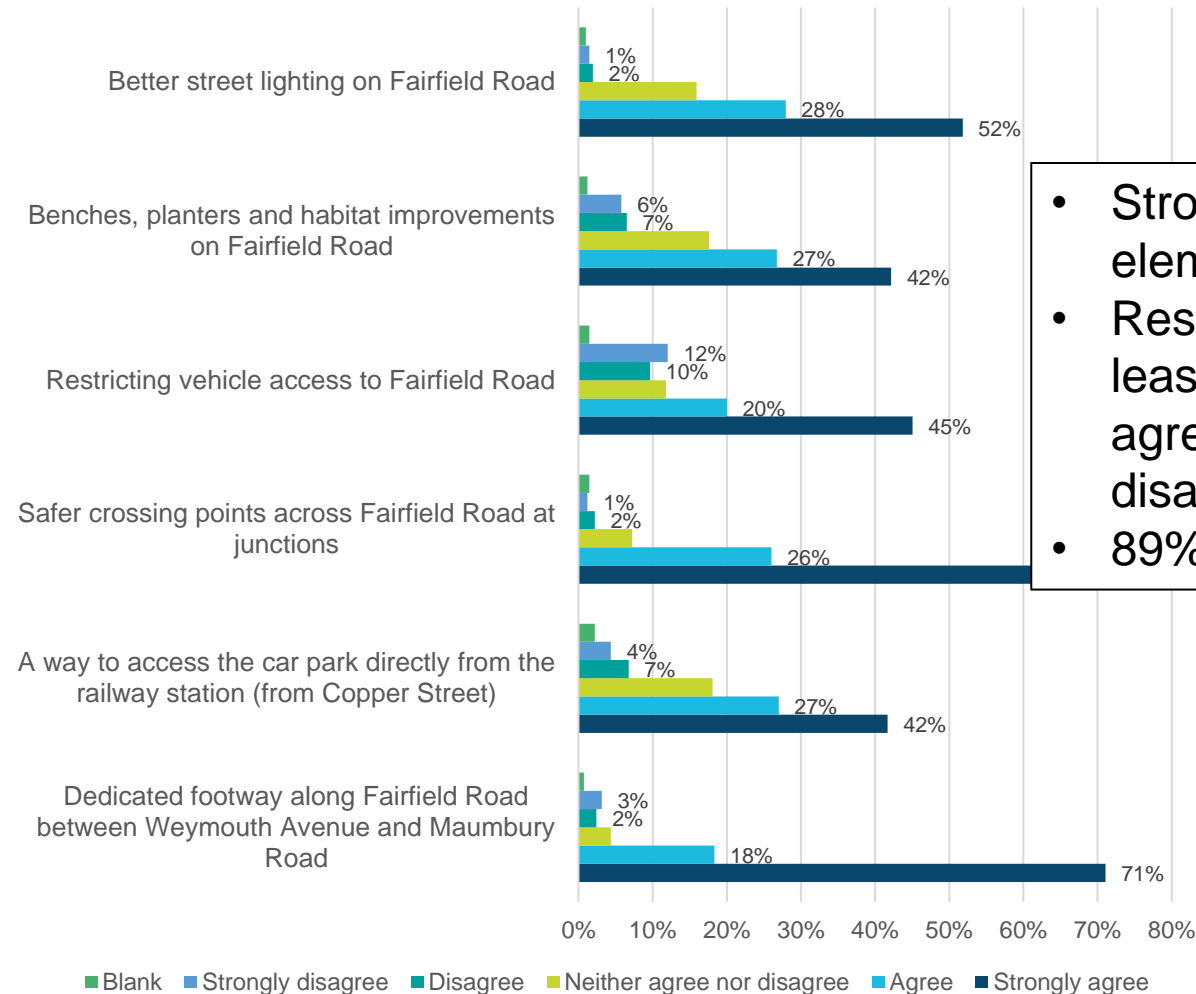

- Strong support for all elements.
- Restricting vehicle access least supported, but still 65% agreements to 22% disagreement
- 89% agreement with footway

# Agreement with scheme elements – disabled people

How do you feel about the individual aspects of the proposal? - all (415) vs disabled people (50)

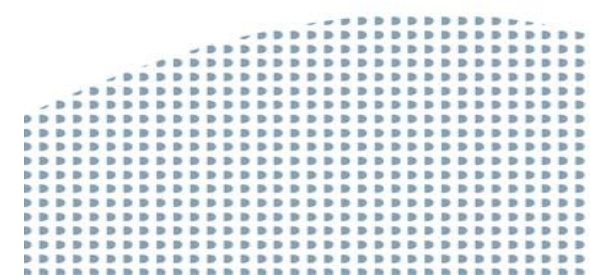
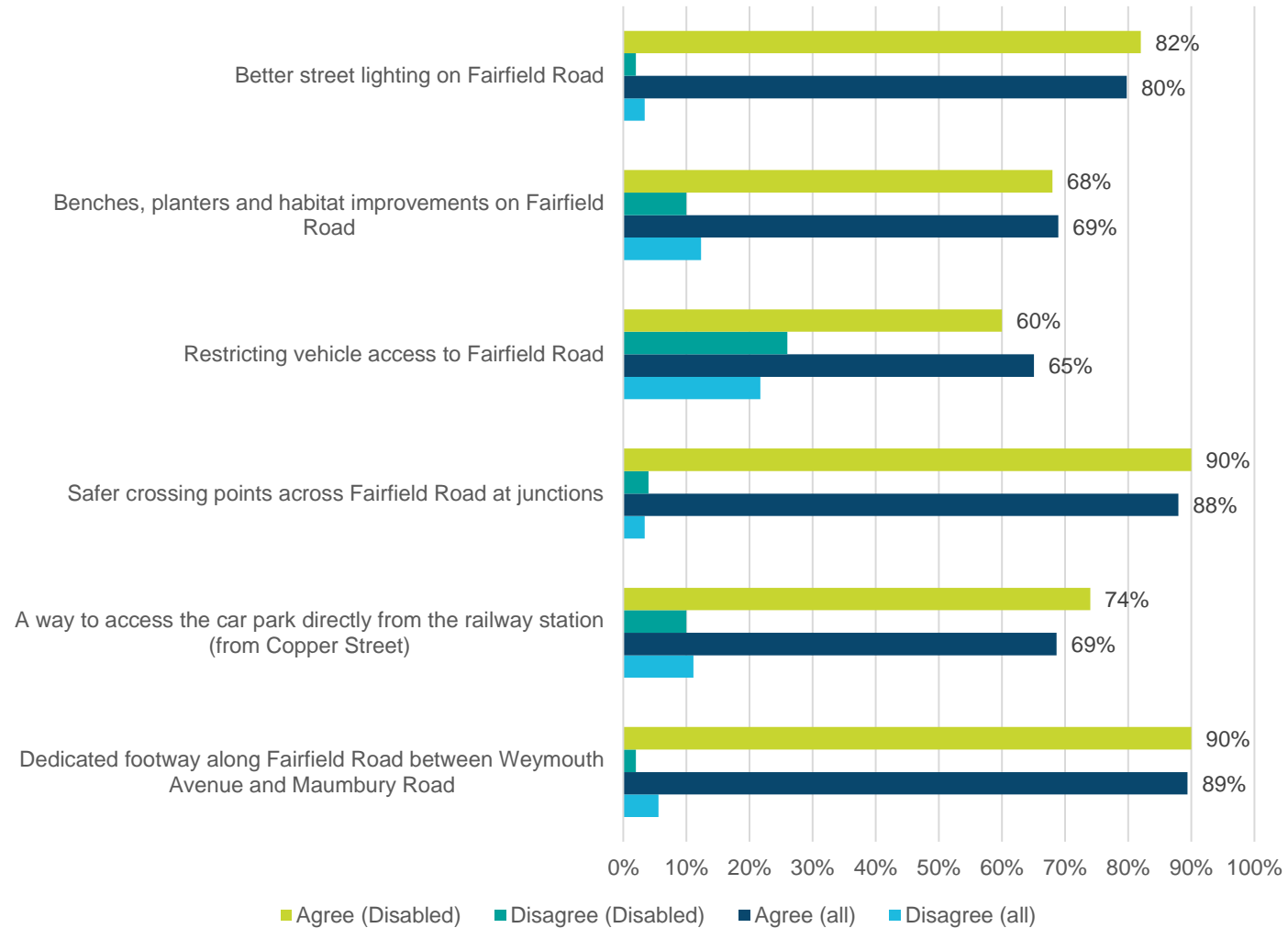

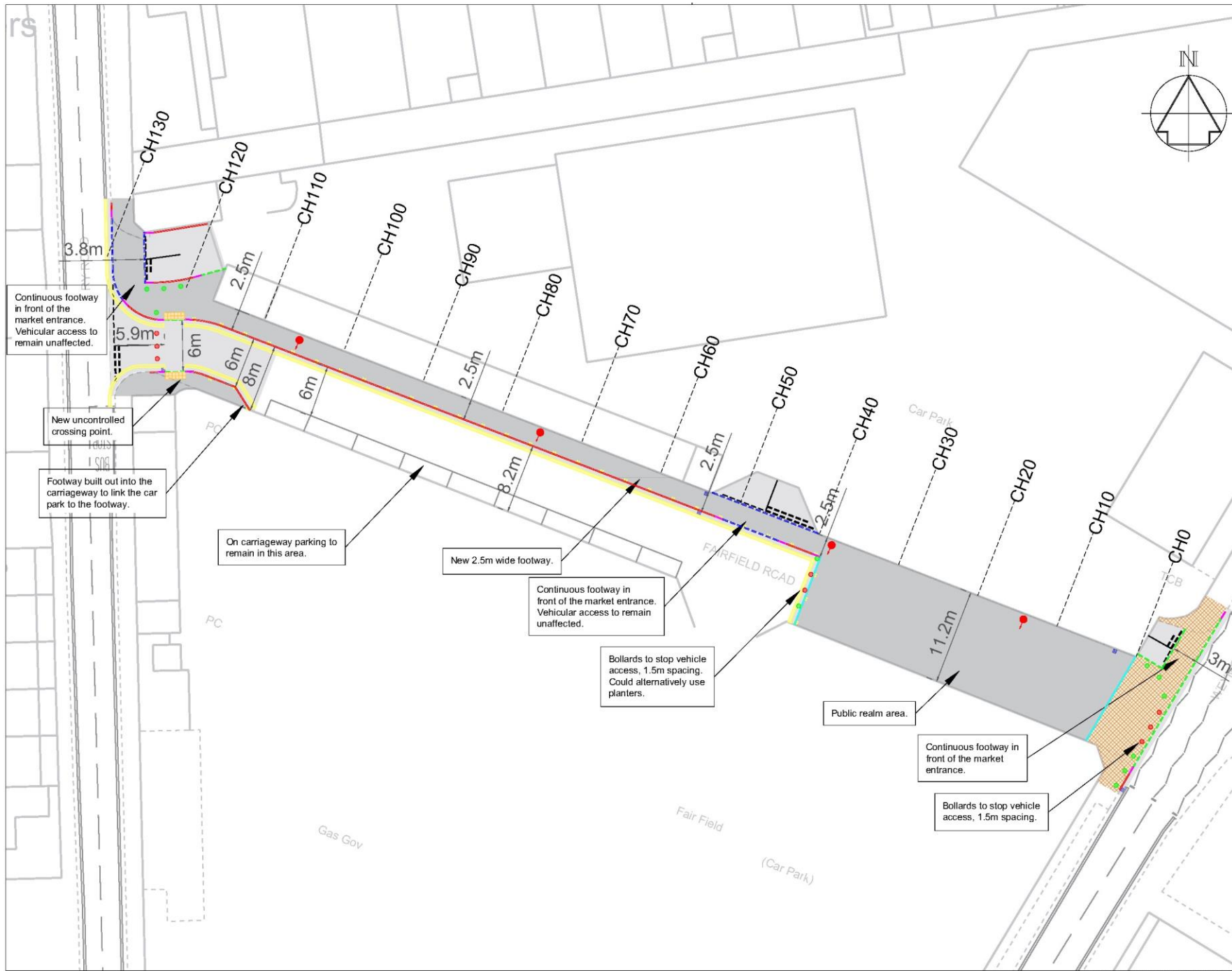

**KEY**

- Proposed kerbing.
- Proposed channels.
- Proposed tactile.
- Proposed slab paving.
- Gullies.
- Footway surfacing.
- Carriageway surfacing.
- Proposed Lining.
- Proposed fixed bollards.
- Proposed socketed bollards.
- Proposed lamp columns.

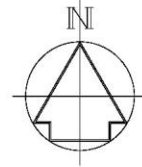

© Crown Copyright and database rights 2023  
 Ordnance Survey 01000090863. You are permitted to use this data solely to enable you to respond to, or interact with, the organisation that provide you with the data. You are not permitted to copy, sub-license, distribute or sell any of this data to third parties in any form.  
 Aerial Photography © LIN/Prospectives 2002 & © Getmapping 2005, 2009 & 2014 Getmapping Plc and Bluekey International Limited [2017]

Orig	Rev	Date	Issue / Remarks	Checked
				ZM



**DORSET HIGHWAYS**  
 Matthew Piles  
 Economic Growth and Infrastructure

Project Title  
 HI1290  
 Fairfield Road

Drawing Title  
 General Arrangement  
 Drawing

Scale (At Site)	Drawn By	Date
1:200	DW	25/08/2023

Drawing Number  
 HI1290\_1\_101\_DD\_General Arrangement

Drawing Status  
 Detailed Design

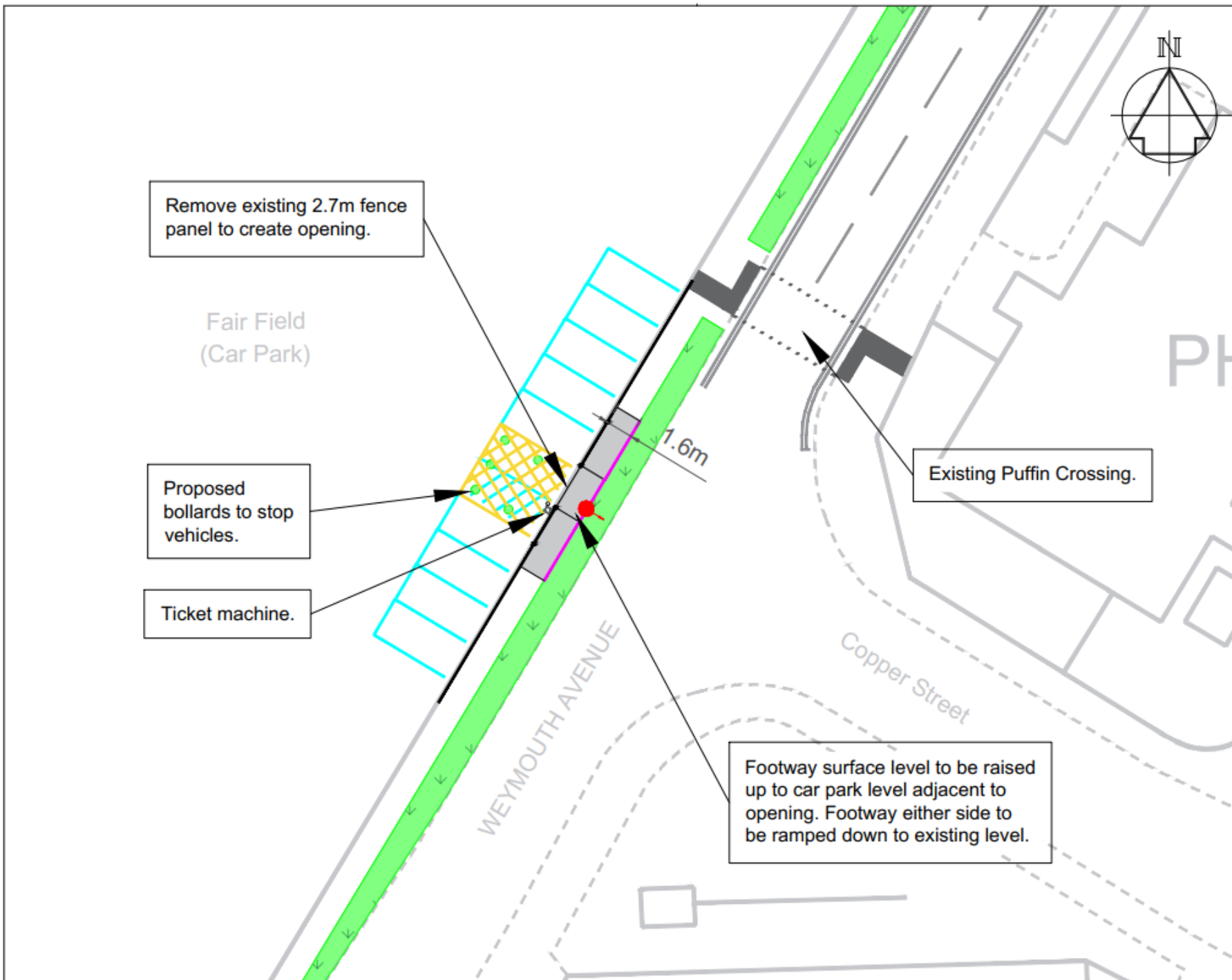

Remove existing 2.7m fence panel to create opening.

Fair Field  
(Car Park)

Proposed bollards to stop vehicles.

Ticket machine.

1.6m

Existing Puffin Crossing.

Footway surface level to be raised up to car park level adjacent to opening. Footway either side to be ramped down to existing level.

**KEY**

- Proposed edging kerbs.
- Proposed footway surfacing.
- Proposed fixed bollards.
- Please refer to drawing H1290\_1\_401\_DD\_Street Furniture for type to be used.
- Proposed lining.
- Existing lamp column.
- Existing lining.
- Existing iron fencing.
- Existing grass verge.



© Crown Copyright and database rights 2023  
Ordnance Survey 100050983. You are permitted to use this data solely to enable you to respond to, or interact with, the application that provides you with the data. You are not permitted to copy, add-to, distribute or sell any of the data in third parties in any form.  
Aerial Photography © Ordnance Survey 2002 & © Geographics 2005, 2009 & 2014. Geomapping Plc and Bluejay International Limited [2017]

City	WIM	Zone	2M
Rev	Date	Issue / Revision	Created



**DORSET HIGHWAYS**  
Matthew Piles  
Economic Growth and Infrastructure

Project Title	H1290 Fairfield Road		
Drawing Title	General Arrangement Drainage		
Scale (H / Vert)	Drawn By	Drawn On	Date
1:200	DW		31/08/2023
Drawing Number	H1290_1_102_DD_GA Copper Street		
Drawing Status	Detailed Design		

# Issues

- Scheme will require full planning permission.
- This will entail evidence of net biodiversity benefit and support preservation of the conservation area.
- Any substantial underground works will require archaeological supervision.
- All of these will entail additional costs.
- Current budget insufficient to cover full public realm scheme: a cheaper option is also under consideration using simpler materials.

# Timescales

- Planning application – Oct / November / December 2023
- Footway / carriageway works – January / February / March 2024
- Further public engagement and design for the public realm scheme – 2024?

# Questions