

Appendix A

Anti-social Behaviour, Crime and Policing Act 2014

The West Dorset Anti-social Behaviour Related Public Spaces Protection Order 2018

West Dorset District Council (“the Council”) hereby makes the following Order:

This Order shall be known as The West Dorset Anti-social Behaviour Related Public Spaces Protection Order 2018 and shall come into force on the 23 April 2018 for a duration of three years.

This Order supersedes the following:

The Alcohol Consumption in Public Places Designation Order for Bridport and West Bay 2005 (which from 20 October 2017 became a Public Spaces Protection Order with the same provisions).

The Alcohol Consumption in Public Places Designation Order for Dorchester 2007 (which from 20 October 2017 became a Public Spaces Protection Order with the same provisions).

This Order has three sections and should be read in conjunction with the related Schedules.

Contents

Section 1 Consumption of Alcohol

Section 2 Intentional Feeding of Gulls

Section 3 Fixed Penalty Notices

Schedule 1 - Map identifying Dorchester Controlled Alcohol Zone – outlined in red and shaded in pink

Schedule 2 – Map identifying Bridport Controlled Alcohol Zone – outlined in red and shaded in pink

Schedule 3 – Map identifying West Bay Controlled Alcohol Zone – outlined in red and shaded in pink

Schedule 4 – Map identifying West Bay Feeding of Gulls Prohibited Area – outlined in red and shaded in pink

Schedule 5 – Map identifying Lyme Regis Feeding of Gulls Prohibited Area – outlined in red and shaded in pink

Schedule 6 – Streets and other public places within the Controlled Alcohol Zones

Schedule 7 – Streets and other public places within the Feeding of Gulls Prohibited Areas

Section 1- The Consumption of Alcohol

- (1) This Section applies to all public places within the land identified and described in Schedules 1, 2, 3 and 6 ("the alcohol restricted area") and imposes the prohibition contained in subsection (2).

Prohibition

- (2) No person shall consume alcohol within the alcohol restricted area in circumstances where a constable or authorised person has directed them not to do so in the reasonable belief that such a direction is necessary to prevent public nuisance, public disorder or anti-social behaviour.
- (3) If a constable or authorised person reasonably believes that a person (P)-
- (a) is or has been consuming alcohol in breach of the prohibition in sub-section (2), or
 - (b) intends to consume alcohol in circumstances in which doing so would be a breach of such prohibition
- he or she may impose a requirement upon P under sub-section 4(a) or 4(b)
- (4) The constable or authorised person may require P-
- (a) not to consume alcohol or anything which the constable or authorised person reasonably believes to be alcohol; or
 - (b) to surrender anything in his or her possession which is, or which the constable or authorised officer reasonably believes to be, alcohol or a container for alcohol
- (5) A person who fails without reasonable excuse to comply with a requirement imposed on him or her under sub-section 4 commits an offence contrary to section 63(6) of the Anti-social Behaviour, Crime and Policing Act 2014 and is liable on summary conviction to a fine not exceeding level 2 on the standard scale.

Section 2 - Intentional Feeding of Gulls

- (1) This Section applies to all public places within the land identified and described in Schedules 4, 5 and 7 ("the feeding of gulls restricted area") and imposes the prohibition contained in subsection (2).

Prohibition

- (2) No person at any time shall provide or deposit food for consumption by gulls within the feeding of gulls restricted area.
- (3) In accordance with section 67 of the Anti-social Behaviour, Crime and Policing Act 2014 it is an offence for a person without reasonable excuse to do anything they are prohibited from doing by section 2(2) of this Order.
- (4) A person guilty of an offence under this section is liable on summary conviction to a fine not exceeding level 3 on the standard scale.

Section 3 – Fixed Penalty Notices

In accordance with Section 68 of the Anti-social Behaviour, Crime and Policing Act 2014, a constable or authorised person may issue a fixed penalty notice to anyone they have reason to believe has committed an offence under this Order. Such notice offers the person to whom it is issued the opportunity to discharge their liability to conviction for the offence by payment of a fixed penalty. The penalty is set at £100.00 to be paid within 28 days, but is reduced to £75.00 if paid within 14 days.

Date: 8 March 2018

THE COMMON SEAL OF WEST
DORSET DISTRICT COUNCIL
Was hereto affixed in the presence of:-

}

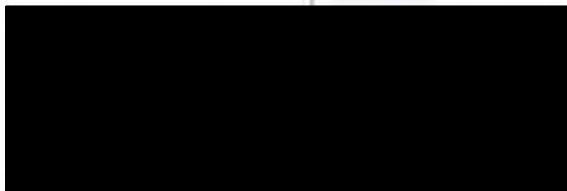

PRINCIPAL REGULATORY LAWYER



15061/18

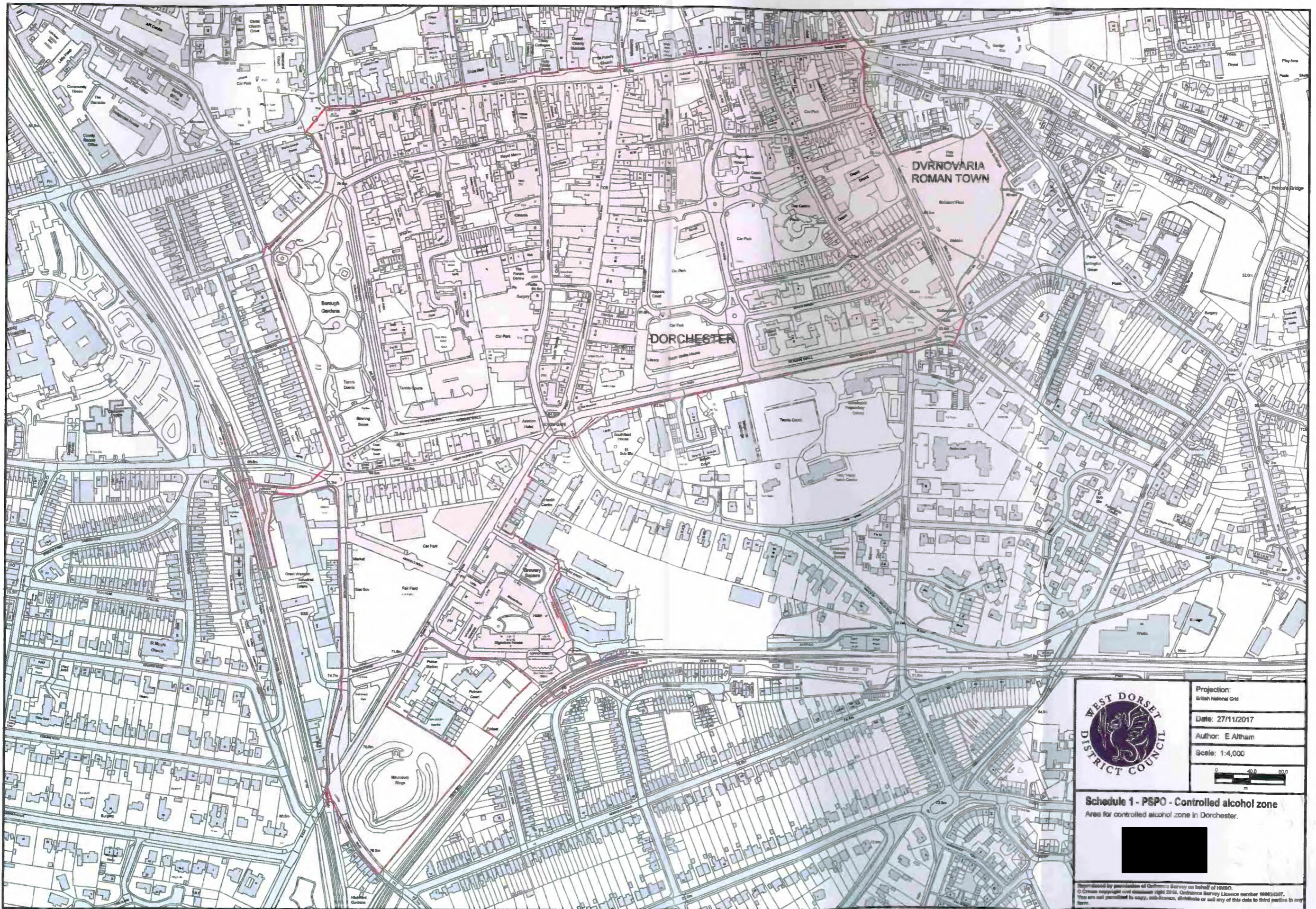

	Projection: British National Grid
	Date: 27/11/2017
	Author: E Altham
	Scale: 1:4,000
	
<p>Schedule 1 - PSPO - Controlled alcohol zone Area for controlled alcohol zone in Dorchester.</p>	
	
<small>Reproduced by permission of Ordnance Survey on behalf of HMGO. © Crown copyright and database right 2016. Ordnance Survey Licence number 100024007. You are not permitted to copy, re-transmit, distribute or sell any of this data to third parties in any form.</small>	



	Projection: British National Grid
	Date: 29/11/2017
	Author: E Altham
	Scale: 1:3,000



Schedule 2 - PSPO - Controlled alcohol zone



Reproduced by permission of Ordnance Survey on behalf of HMRSO. © Crown copyright and database right 2017. Ordnance Survey Licence number 100024387. You are not permitted to copy, re-transmit, distribute or sell any of this data to third parties in any form.

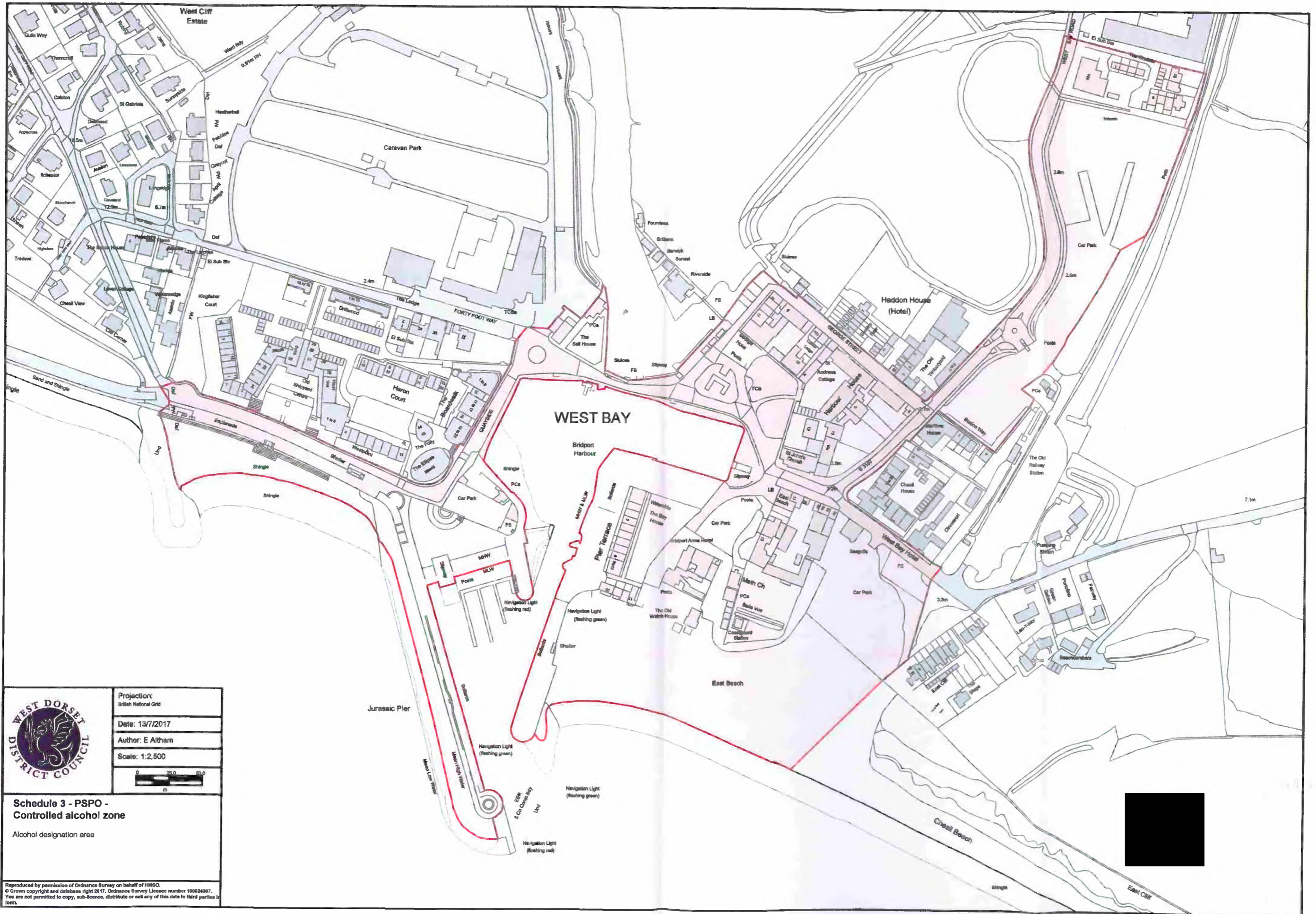

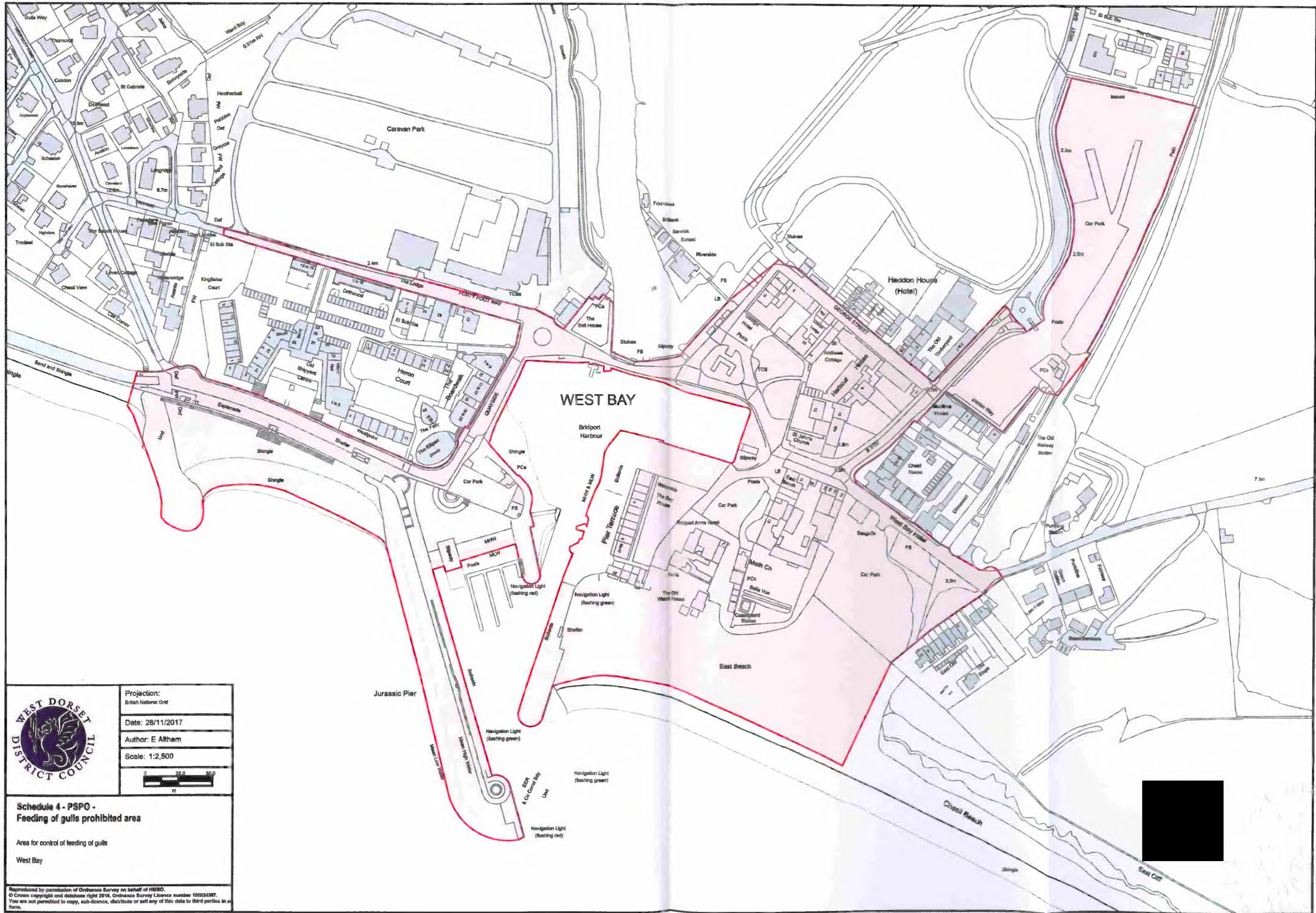

Projection:
 British National Grid
 Date: 28/11/2017
 Author: E Altham
 Scale: 1:2,500

Schedule 4 - PSPO - Feeding of gulls prohibited area

Area for control of feeding of gulls
 West Bay

Reproduced by permission of Ordnance Survey on behalf of HMRSO.
 © Crown copyright and database right 2016. Ordnance Survey Licence number 100034307.
 You are not permitted to copy, sub-licence, distribute or sell any of this data to third parties in a form.

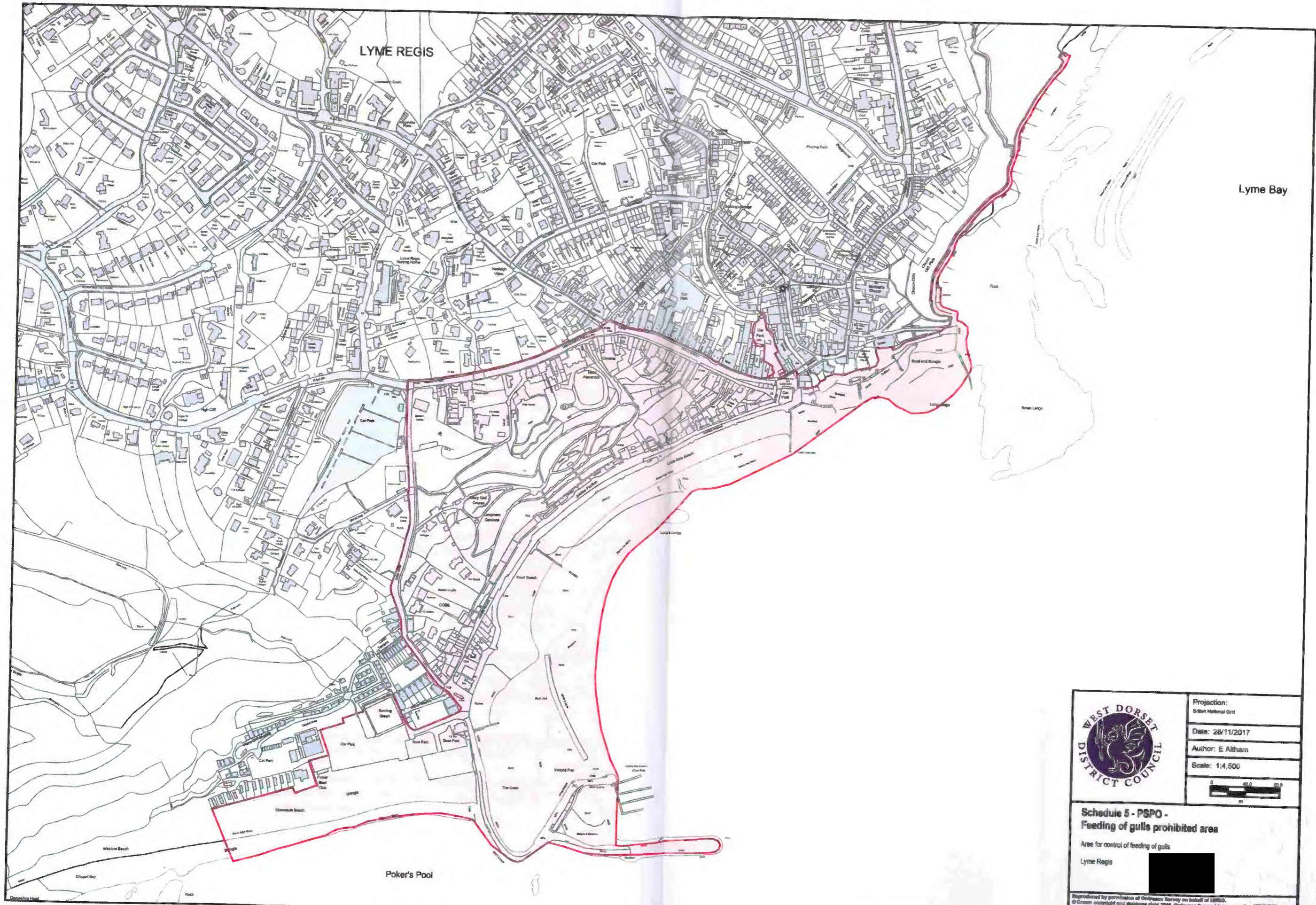

	Projection: British National Grid
	Date: 28/11/2017
	Author: E Altham
	Scale: 1:4,500
	
Schedule 5 - PSPO - Feeding of gulls prohibited area	
Area for control of feeding of gulls Lyme Regis	
<small> Reproduced by permission of Ordnance Survey on behalf of HMNSO. © Crown copyright and database right 2016. Ordnance Survey Licence number 100020877. You are not permitted to copy, re-use, distribute or sell any of this data to third parties in any form. </small>	

SCHEDULE 6 – Controlled Alcohol Zones

DORCHESTER

The controlled alcohol zone (“the zone”) includes the following streets and public places which form the zone boundary: the junction of Salisbury Street and Swan Bridge; west on High East Street leading onto High West Street to West Gate; south onto Albert Road leading to Cornwall Road to the junction of Great Western Cross; west to Dorchester West Station approach road, including all station platforms; south onto Maumbury Road; to the railway bridge at Maumbury Rings; along the southeast and then northeast boundary of Maumbury Rings to Weymouth Avenue; northeast along Weymouth Avenue to junction of Copper Street to Dorchester South Station approach, including all station platforms; onto Pope Street and northwest on Eldridge Street to rejoin Weymouth Avenue; northeast to South Gate and onto South Walks Road to junction of Gallows Hill; to the northeast, northwest and southwest boundaries of Salisbury Field to junction of Salisbury Street/Walk; north to Swan Bridge.

Streets within the zone: Acland Road, Albert Road, All Saints Road, Allington Street, Charles Street, Church Street, Copper Street, Cornhill, Cornwall Road, Durngate Street, Fairfield Road, Gallows Hill, Great Western Road, High East Street, High West Street, Icen Way, Linden Avenue, Maumbury Road, New Street, Pope Street, Prince’s Street, Salisbury Street, Somerleigh Road, South Street, South Walks Road, Trinity Street, Upper Fairfield Road, West Walks Road, Weymouth Avenue and Wollaston Road.

Other public areas within the zone: Antelope Walk, Borough Gardens, Bowling Alley Walk, Dorchester West Railway Station, The Forum Centre, Gallows Hill, Hardye Arcade, Maumbury Rings, Napiers Mite, Passageway between Trinity Street (by the Trinity Club) and Somerleigh Road, Passageway between Trinity Street and South Street (by bank), Passageway from Trinity Street (by public house and taxi rank) to South Street, Salisbury Field, Salisbury Walk, South Street Passage (between South Street and Charles Street), South Walks, Tennis Courts by West Walks Road, Tudor Arcade, West Walks, Brewery Square, Dorchester South Railway Station and the Public Car Parks at Acland Road, Fairfield car parks (Market place), Trinity Street, Durngate Street, Wollaston Field and Old Market.

BRIDPORT

The controlled alcohol zone (“the zone”) includes the following streets and public places which form the main zone boundary: Barrack Street along Rax Lane including the driveway, land and area named Mountfield Council Offices; along Rax Lane to junction of Victoria Grove; south to West Street and then west to junction of West End Row; south to (and including) the footbridge joining Bridport Coach Station and Plottingham Playing Fields; south from the footbridge then eastwards to Tannery Road and the junction of Hope Terrace and St Michael’s Lane; southwards to junction of Gundry Lane; east to South Street; south as far as house number 107 and then east along Church Street, northeast along King Street to Barrack Street.

Streets within the zone: Barrack Street, Brydian Mews, Chancery Lane, Church Street, Downes Street, East Street, Folly Mill Lane, Globe Lane, Gundry Lane, Hope Terrace, King Street, Lilliput Lane, North Street, Rax Lane, Rope Walks, South Street, St Michael’s Lane, Tannery Road, The Tanyard, Victoria Grove and West Street.

Other public places within the zone: Borough Gardens, Bucky Doo Square, Mountfield Council Offices, and the Public Car Parks at East Street, Hope Terrace, Rope Walks, West Street.

Public gardens and fields within the zone: the land named Riverside Gardens to the east of the town; the area named Plottingham Playing fields to the west of the town; the area named St Marys Playing Field and play area to the south west of the town.

WEST BAY

The controlled alcohol zone ("the zone") includes the following streets and public places which form the zone boundary: the Chalets by West Bay Road, southwards onto George Street and follow around to include the road and The Salt House and grounds; southwest onto Quayside; northwest along the Esplanade to start of West Cliff Road; southeast to include the shingle and beach south of the Esplanade; to include the Jurassic Pier, slipway and the Mound; from the slipway by St John's Church northwest to the boundary of West Bay harbour; to the west of Pier Terrace, south to end of pier; east along East Beach; northeast at junction of Chesil Beach, north to Station Road; north west along West Bay to Station Way; north to include all the boundary area of West Bay Road Car Park to The Chalets.

Streets within the zone: The Esplanade, Quayside, Station Road, Station Way and West Bay Road.

Other public places within the zone: Beach south of the Esplanade, East Beach, Jurassic Pier, The Pier, Pier Terrace, The Quay and the Public Car Parks at Bridport Arms, East Beach, The Esplanade, The George Hotel, The Mound, Quayside, Station Yard and West Bay Road.

SCHEDULE 7 – Feeding of Gulls Prohibited Areas

WEST BAY

The prohibited area includes the following streets and public places which form the area boundary: the Chalets by West Bay Road, southwards onto George Street and follow around to include the road and The Salt House and grounds; southwest onto Quayside; northwest along the Esplanade to start of West Cliff Road; southeast to include the shingle and beach south of the Esplanade; to include the Jurassic Pier, slipway and the Mound; from the slipway by St John's Church northwest to the boundary of West Bay harbour; to the west of Pier Terrace, south to end of pier; east along East Beach; northeast at junction of Chesil Beach, north to Station Road; north west along West Bay to Station Way; north to include all the boundary area of West Bay Road Car Park to The Chalets.

Streets within the prohibited area: Forty Foot Way, The Esplanade, Quayside, Station Road, Station Way and West Bay Road.

Other public places within the prohibited area: Beach south of the Esplanade, East Beach, Jurassic Pier, The Pier, Pier Terrace, The Quay, and the Public Car Parks at Bridport Arms, East Beach, The Esplanade, The George Hotel, The Mound, Quayside, Station Yard and West Bay Road.

LYME REGIS

The prohibited area includes the following streets and public places which form the area boundary: the junction of Bridge Street and Cobb Gate; to include Bridge Street car park; north west onto Broad Street; Langmoor Close; Pound Street to junction with Cobb Road; southwards to Ozone Terrace; Bowling Green; Monmouth Beach and public car park; boat parks; The Cobb; Victoria Pier; Front Beach; Jubilee Pavilion; Marine Parade; Cobb Gate Beach and public car park; to extend along the sea wall above Church Cliffs north to the Charmouth Road car park steps, namely;

Streets within the prohibited area: Broad Street, Cart Road, Cobb Road, George Street, Langmoor Close, Pound Street, Style Lane

Other public places within the prohibited area: Marine Parade, Bell Cliff, the harbour, slipway and sea walls, the entrance to Cobb Road, Ozone Terrace, the entrance to the public car park and boat park, and the harbour wall Cobb Gate car park and the esplanade extending from it eastwards up to its junction with Long Entry and known as Gunn Cliff Walk, to extend along the sea wall above Church Beach, and up to the Charmouth Road car park via the provided steps.

DORSET COUNCIL**West Dorset Anti-social Behaviour Related Public Spaces
Protection Order 2018****Anti-social Behaviour, Crime and Policing Act 2014
Section 60****Record of Extension**

Pursuant to section 60(2) of the Anti-social Behaviour, Crime and Policing Act 2014, the period that the Dorset Council West Dorset Anti-social Behaviour Related Public Spaces Protection Order 2018 ("the Order") has effect was extended from the original date of expiry, 23 April 2021, to 22 April 2022.

The decision to extend the Order was made by the Dorset Council Cabinet on 6 April 2021 and became effective on 15 April 2021.

The Order will now expire on 22 April 2022.

Dated this 17 day of May 2021

Signed:

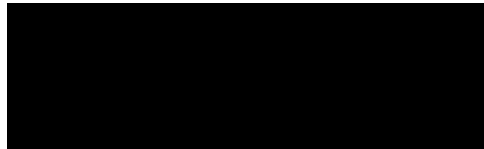

Authorised Signatory

The Anti-social Behaviour, Crime and Policing Act 2014

The Weymouth & Portland Anti-social Behaviour Related Public Spaces Protection Order 2018

Weymouth & Portland Borough Council (“the Council”) hereby makes the following Order:

This Order shall be known as The Weymouth & Portland Anti-social Behaviour Related Public Spaces Protection Order 2018 and shall come into force on the 20 August 2018 for a duration of three years.

When in force this Order supersedes the following:

The Alcohol Consumption in Public Places Designation Order for Weymouth & Portland 2002 (which from 20 October 2017 became a Public Spaces Protection Order with the same provisions).

Byelaw No.11 of the Borough of Weymouth Byelaws as to the Seashore and Promenades 1976, which regulates the riding of bicycles on promenades, so far as it relates to the Cycling Restricted Area defined in Section 4(1).

This Order has five sections and should be read in conjunction with the related Schedules.

Contents

- Section 1** Consumption of Alcohol
- Section 2** Intentional Feeding of Gulls
- Section 3** Begging
- Section 4** Cycling on the Promenade
- Section 5** Fixed Penalty Notices

- Schedule 1** – Maps 1a, 1b, 1c, 1d and 1e (Alcohol) Weymouth
- Schedule 2** – Map (Alcohol) Portland
- Schedule 3** – Map (Gulls)
- Schedule 4** – Map (Begging)
- Schedule 5** – Map (Cycling)

Section 1 - Consumption of Alcohol

- (1) This Section applies to all public places identified and described in the maps in Schedules 1 and 2 (“the alcohol restricted area”) and imposes the prohibition contained in sub-section (2).

Prohibition

- (2) No person shall consume alcohol within the alcohol restricted area in circumstances where a constable or authorised officer has directed them not to do so, in the reasonable belief that such a direction is necessary to prevent public nuisance, public disorder or anti-social behaviour.
- (3) If a constable or authorised officer reasonably believes that a person (P) -
- (a) is or has been consuming alcohol in breach of the prohibition in sub-section (2), or

(b) intends to consume alcohol in circumstances in which doing so would be a breach of such prohibition

he or she may impose a requirement upon P under sub-section 4(a) or 4(b).

- (4) The constable or authorised person may require P -
- (a) not to consume alcohol or anything which the constable or authorised person reasonably believes to be alcohol; or
 - (b) to surrender anything in his or her possession which is, or which the constable or authorised officer reasonably believes to be, alcohol or a container for alcohol.
- (5) A person who fails without reasonable excuse to comply with a requirement imposed on him or her under sub-section 4 commits an offence contrary to section 63(6) of the Anti-social Behaviour, Crime and Policing Act 2014 and is liable on summary conviction to a fine not exceeding level 2 on the standard scale.

Section 2 - Intentional Feeding of Gulls

- (1) This Section applies to all public places identified and described in the Schedule 3 map (“the feeding of gulls restricted area”) and imposes the prohibition contained in sub-section (2).

Prohibition

- (2) No person at any time shall provide or deposit food for consumption by gulls within the feeding of gulls restricted area.
- (3) In accordance with section 67 of the Anti-social Behaviour, Crime and Policing Act 2014 it is an offence for a person without reasonable excuse to do anything they are prohibited from doing by section 2(2) of this Order.
- (4) A person guilty of an offence under this section is liable on summary conviction to a fine not exceeding level 3 on the standard scale.

Section 3 - Begging

- (1) This Section applies to all public places identified and described in the Schedule 4 map (“the begging restricted area”) and imposes the prohibitions contained in sub-sections (2) and (3) below.

Prohibitions

- (2) Any person in the begging restricted area is prohibited from, at any time, placing themselves in a position to beg or solicit money.
- (3) Any person being alone or part of a group in the begging restricted area is prohibited from making verbal, non-verbal or written requests for goods, money or donations, unless they are authorised to do so by a Street Collection Permit issued by the Council.
- (4) In accordance with section 67 of the Anti-social Behaviour, Crime and Policing Act 2014 it is an offence for a person without reasonable excuse to do anything they are prohibited from doing by sections 3(2) or 3(3) of this Order.

- (5) A person guilty of an offence under this section is liable on summary conviction to a fine not exceeding level 3 on the standard scale.

Section 4 - Cycling on the Promenade

- (1) This Section applies to the public place called the Promenade, Weymouth, between the Pavilion and the junction of the Promenade with Preston Road ("the cycling restricted area"), which is identified in the Schedule 5 map, and imposes the prohibitions contained in sub-sections (2) and (3) below.

Prohibitions

- (2) No person shall cycle on the Promenade between the hours of 10:00hrs and 17:30hrs between Good Friday and 31 October annually (both dates inclusive).
- (3) No person shall cycle on the Promenade, at any time, in such a manner as to cause danger or give reasonable grounds for annoyance to other persons using the Promenade.
- (4) In accordance with section 67 of the Anti-social Behaviour, Crime and Policing Act 2014 it is an offence for a person without reasonable excuse to do anything they are prohibited from doing by sections 4(2) or 4(3) of this Order.
- (5) A person guilty of an offence under this section is liable on summary conviction to a fine not exceeding level 3 on the standard scale.

Section 5 – Fixed Penalty Notices

In accordance with Section 68 of the Anti-social Behaviour, Crime and Policing Act 2014, a constable or authorised person may issue a Fixed Penalty Notice (FPN) to anyone they have reason to believe has committed an offence under this Order. Such notice offers the person to whom it is issued the opportunity to discharge their liability to conviction for the offence by payment of a fixed penalty. The penalty is set at £100.00 to be paid within 28 days, but is reduced to £75.00 if paid within 14 days.

Date: 10th July 2018

THE COMMON SEAL OF WEYMOUTH &
PORTLAND BOROUGH COUNCIL
Was hereto affixed in the presence of:-

}

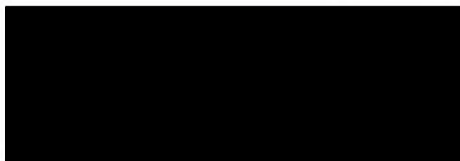

PRINCIPAL REGULATORY LAWYER



744/18



Weymouth & Portland
Borough Council

Projection:
British National Grid

Date: 06/07/2018

Author: E Altham

Scale: 1:12,500



Public Spaces Protection Order

Schedule 1 - Map 1a (Alcohol) Weymouth

This Order covers all streets and other public places, including the promenade, within the red boundary and shaded in blue.

Reproduced by permission of Ordnance Survey on behalf of HMSO.
© Crown copyright and database right 2018. Ordnance Survey Licence number 100019690.
You are not permitted to copy, sub-licence, distribute or sell any of this data to third parties in any form.

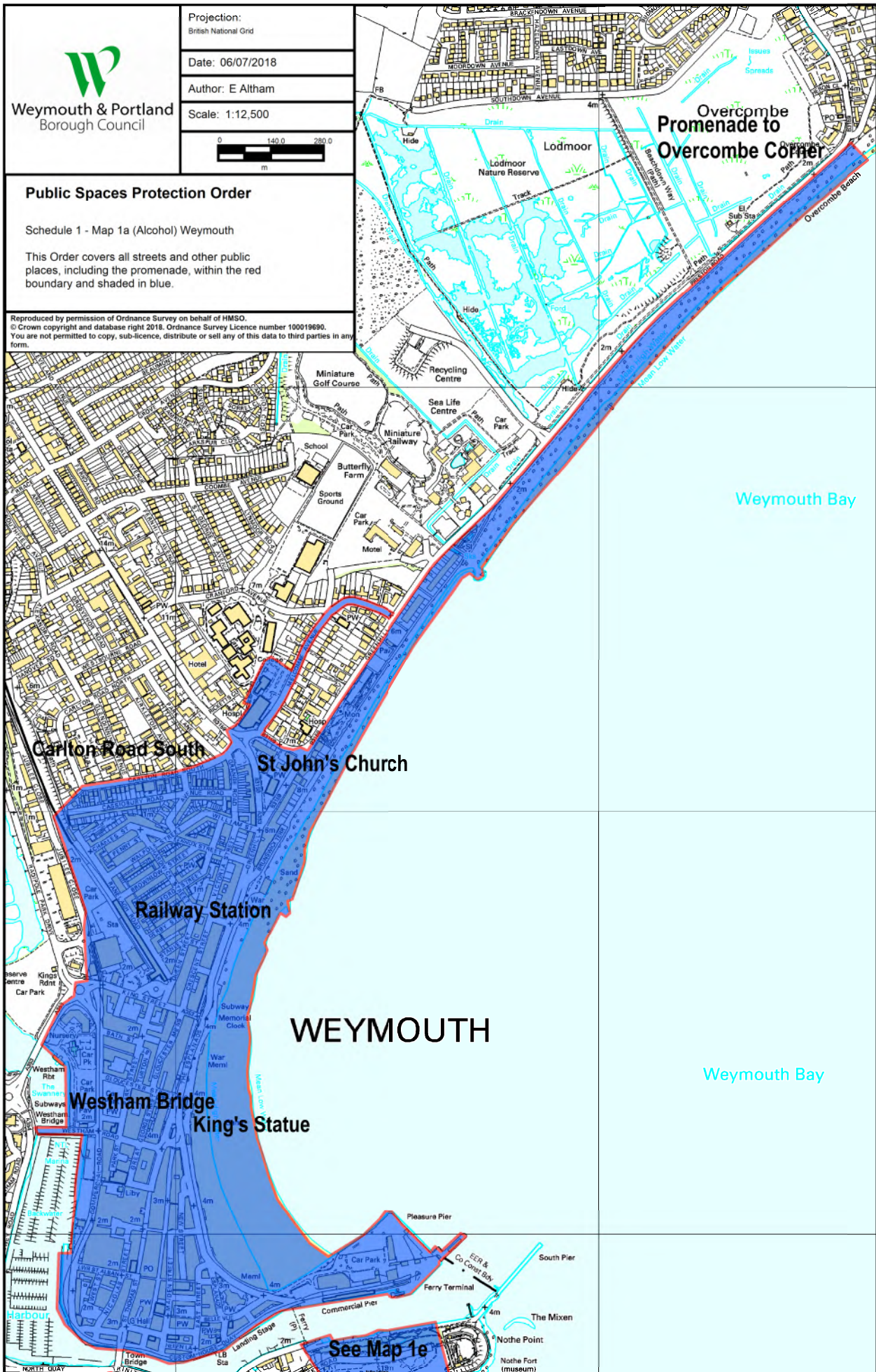



Weymouth & Portland
Borough Council

Projection:
British National Grid

Date: 6/7/2018

Author: E Altham

Scale: 1:2,500

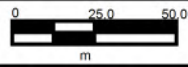

Public Spaces Protection Order

Schedule 1 - Map 1b (Alcohol) Weymouth
Rodwell Trail (Abbotsbury Road to Chickerell Road)
Westwey House, Westwey Road

This Order covers all streets and other public places,
within the red boundary and shaded in blue.

Reproduced by permission of Ordnance Survey on behalf of HMSO.
© Crown copyright and database right 2018. Ordnance Survey Licence number 100024307.
You are not permitted to copy, sub-licence, distribute or sell any of this data to third parties in any form.

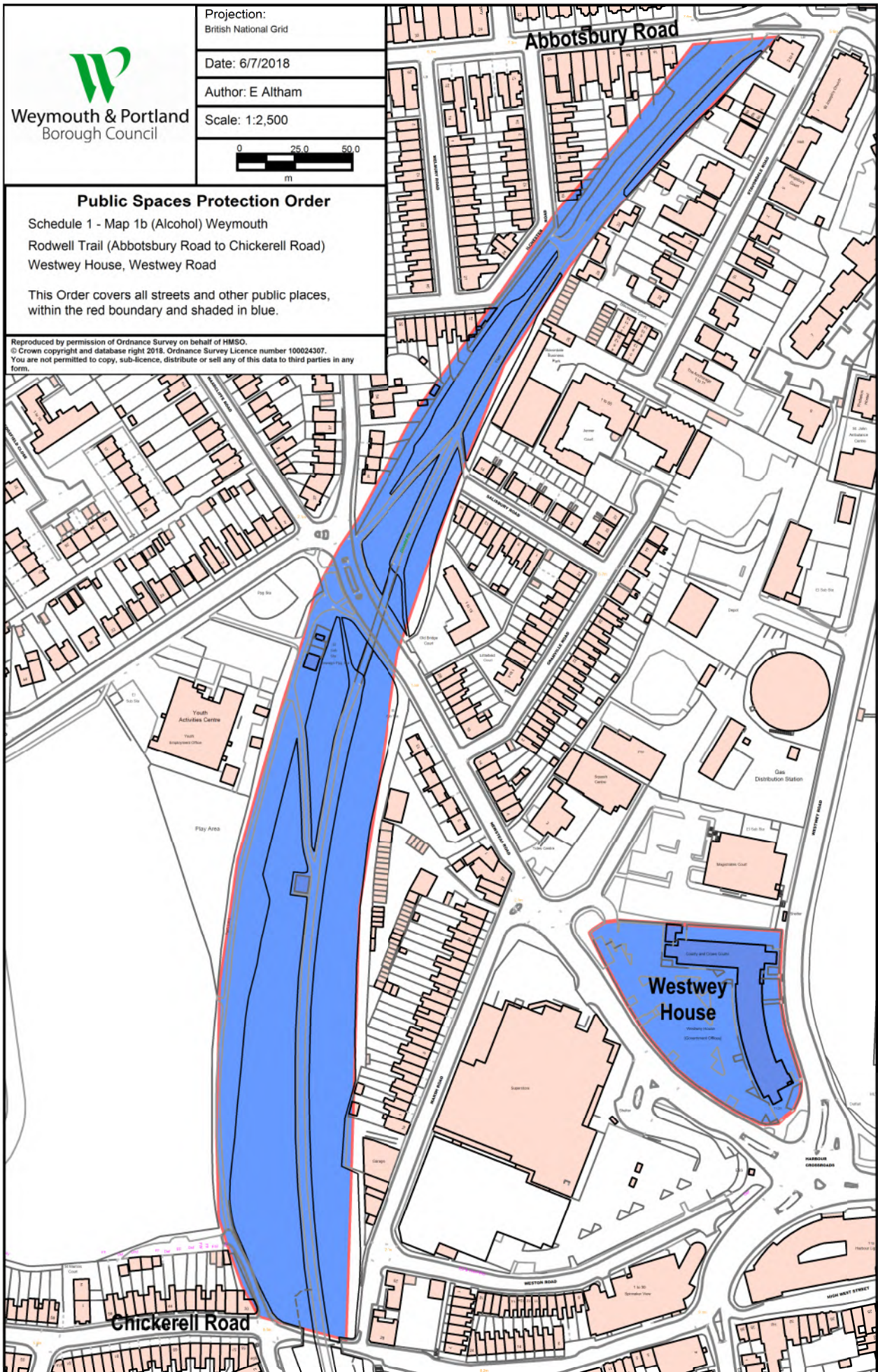



Weymouth & Portland
Borough Council

Projection:
British National Grid

Date: 6/7/2018

Author: E Altham

Scale: 1:1,250

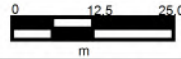

Public Spaces Protection Order

Schedule 1 - Map 1c (Alcohol) Weymouth

Chapelhay Gardens and Steps

This Order covers all other public places, within the red boundary and shaded blue.

Reproduced by permission of Ordnance Survey on behalf of HMSO.
© Crown copyright and database right 2018. Ordnance Survey Licence number 100024307.
You are not permitted to copy, sub-licence, distribute or sell any of this data to third parties in any form.

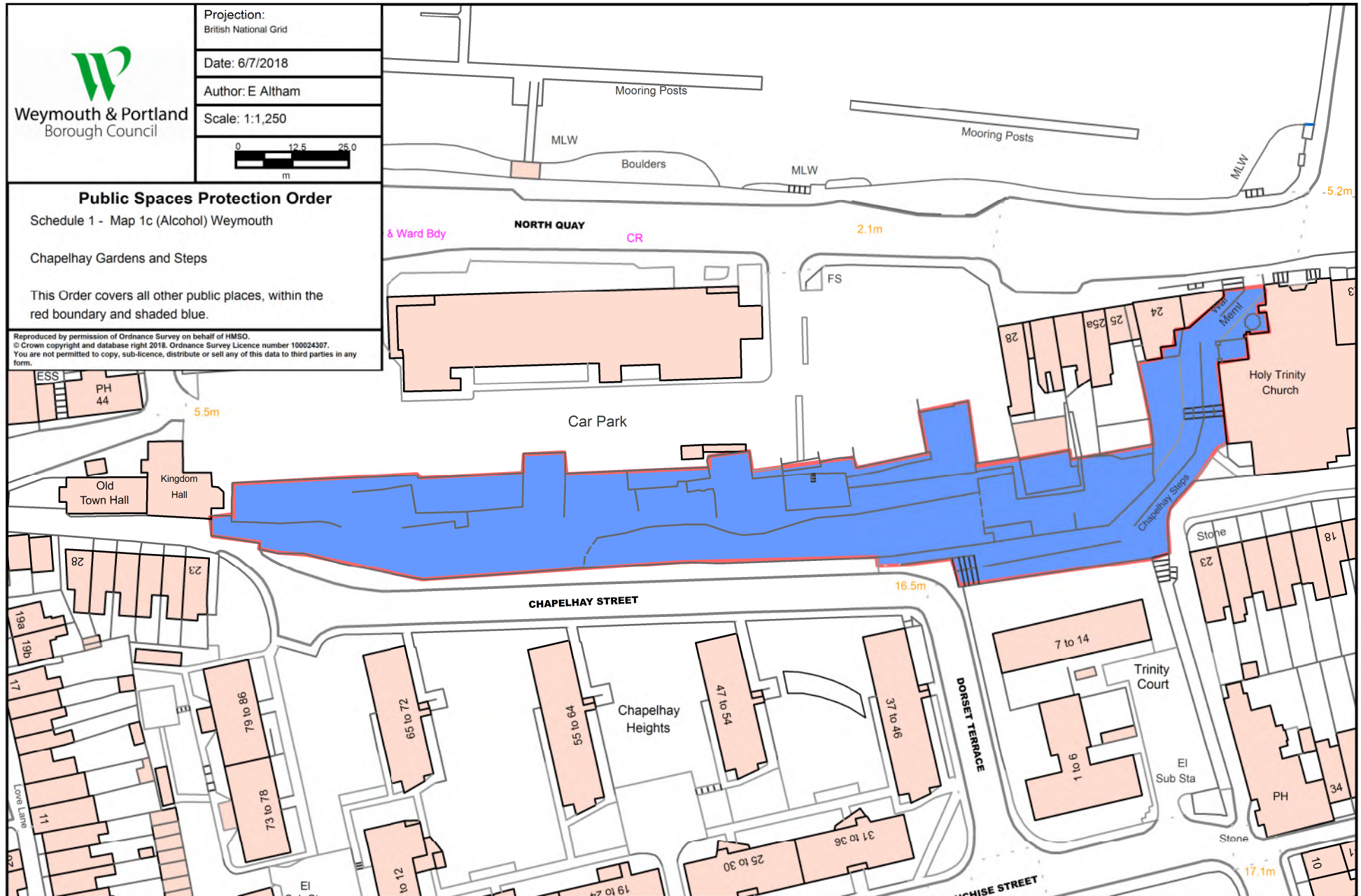

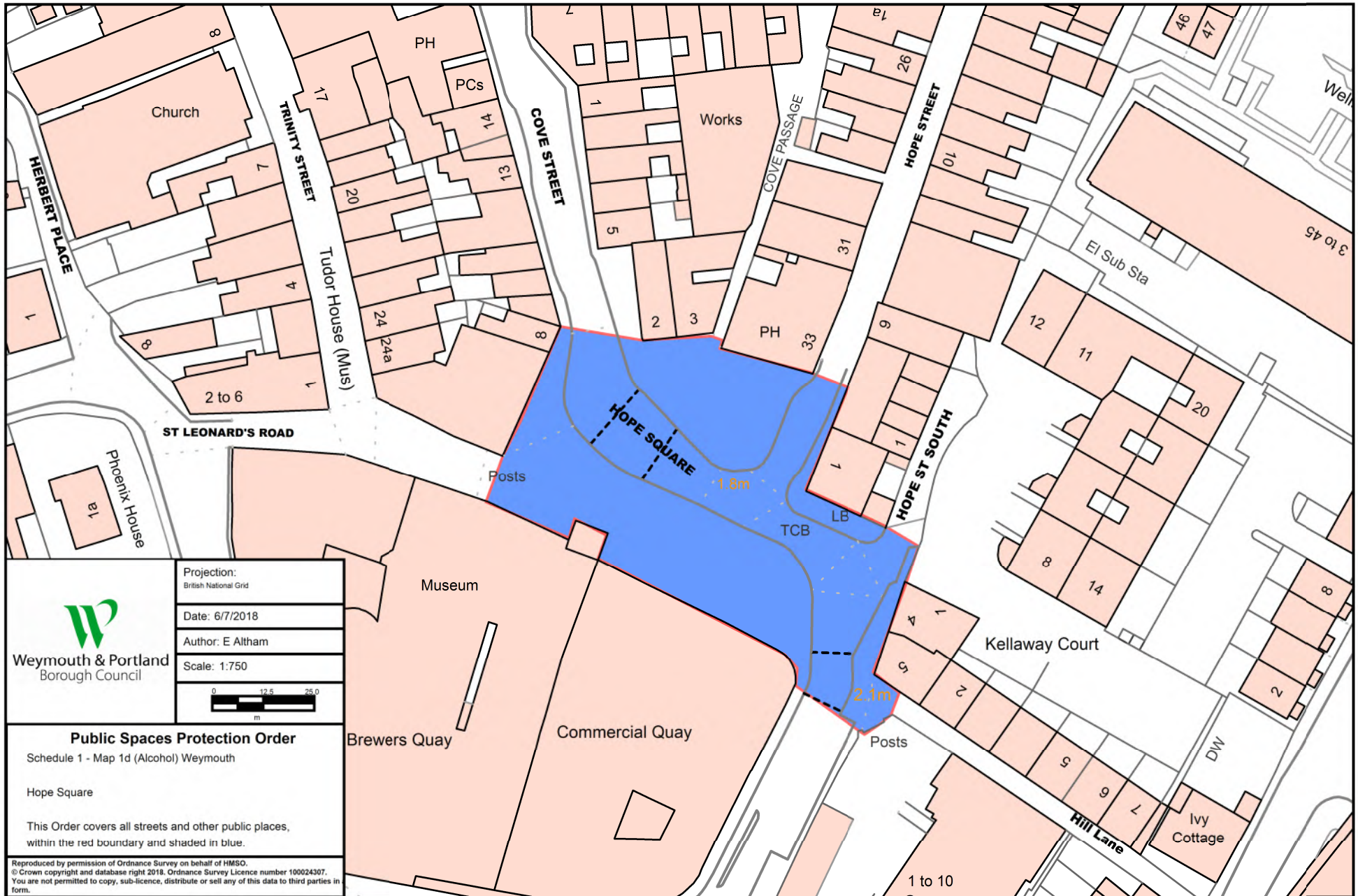

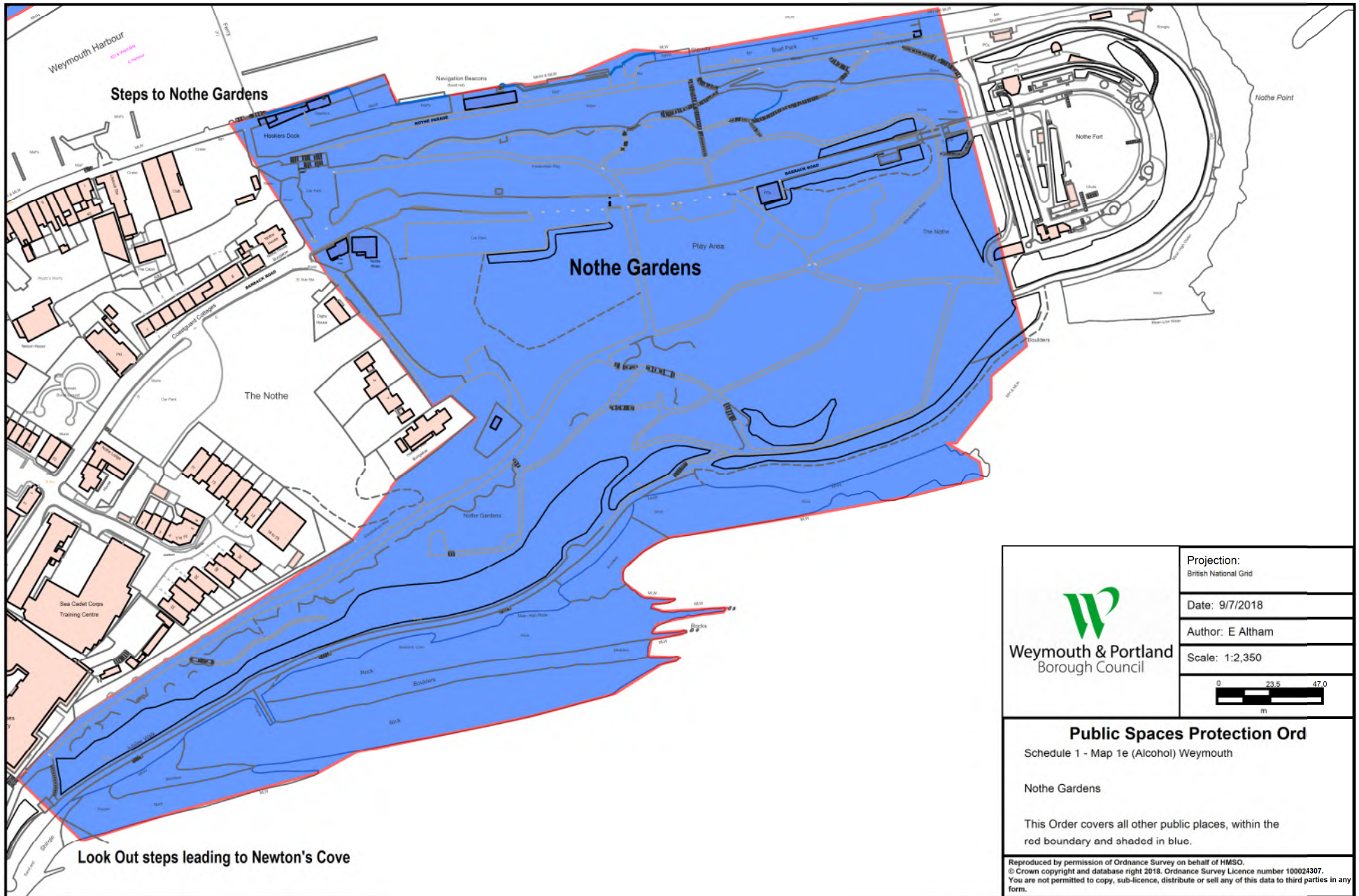

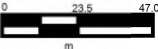
 <p>Weymouth & Portland Borough Council</p>	Projection: British National Grid
	Date: 9/7/2018
	Author: E Altham
	Scale: 1:2,350
	

Public Spaces Protection Ord
 Schedule 1 - Map 1e (Alcohol) Weymouth

Nothe Gardens

This Order covers all other public places, within the red boundary and shaded in blue.

Reproduced by permission of Ordnance Survey on behalf of HM50.
 © Crown copyright and database right 2018. Ordnance Survey Licence number 10004397.
 You are not permitted to copy, sub-licence, distribute or sell any of this data to third parties in any form.



Weymouth & Portland
Borough Council

Projection:
British National Grid

Date: 6/7/2018

Author: E Altham

Scale: 1:750

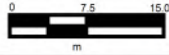

Public Spaces Protection Order

Schedule 2 - Map (Alcohol) Portland

Easton Square

This Order covers all streets and other public places,
within the red boundary and shaded in blue.

Reproduced by permission of Ordnance Survey on behalf of HMSO.
© Crown copyright and database right 2018. Ordnance Survey Licence number 100024307.
You are not permitted to copy, sub-licence, distribute or sell any of this data to third parties in any form.

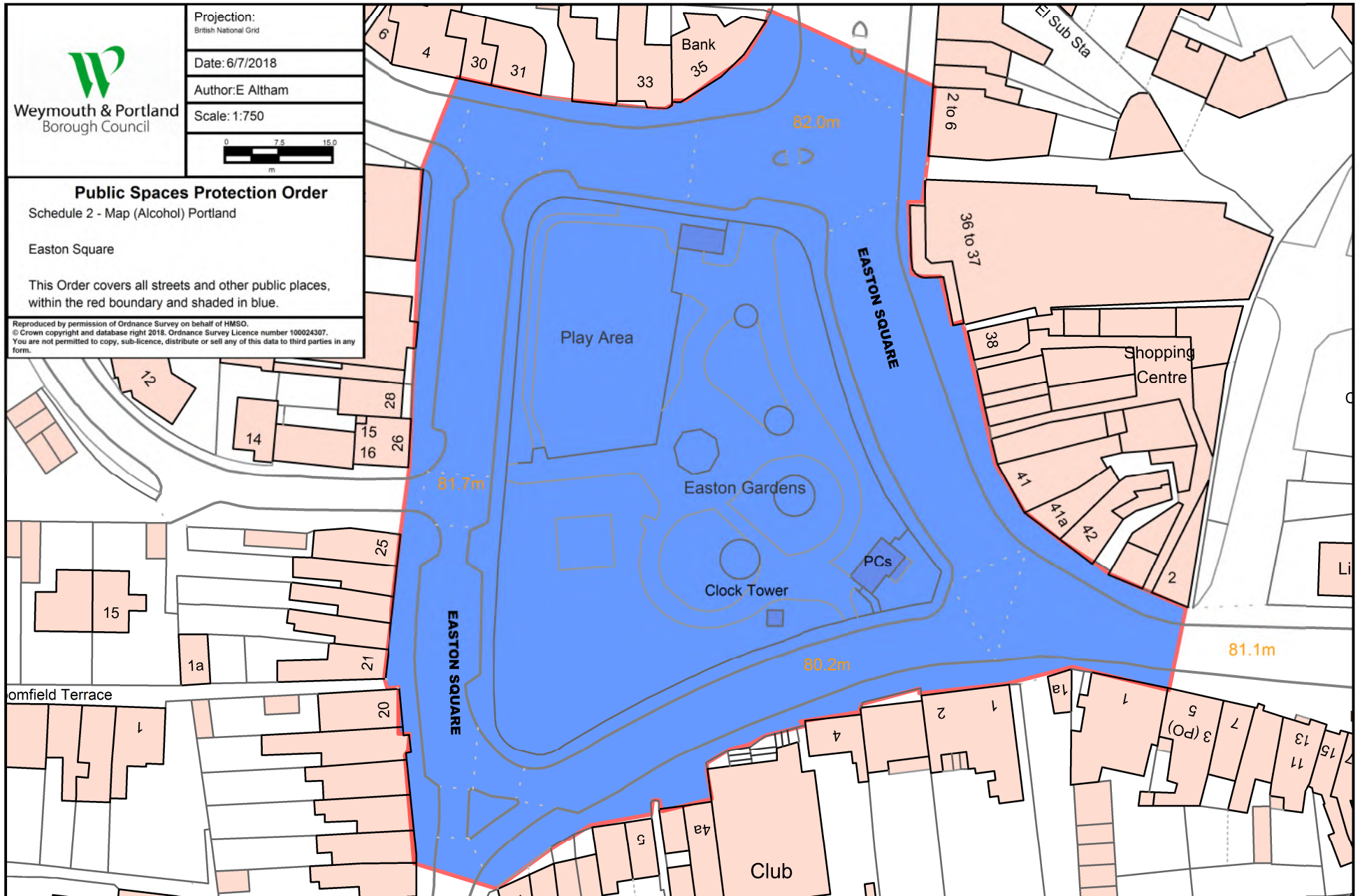



Weymouth & Portland
Borough Council

Projection:
British National Grid

Date: 06/07/2018

Author: E Altham

Scale: 1:9,000

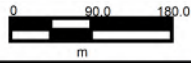

Public Spaces Protection Order

Schedule 3 - Map (Gulls)

This Order covers all streets and public places, including the promenade, within the red boundary.

Reproduced by permission of Ordnance Survey on behalf of HMSO.
© Crown copyright and database right 2018. Ordnance Survey Licence number 100019690.
You are not permitted to copy, sub-licence, distribute or sell any of this data to third parties in any form.

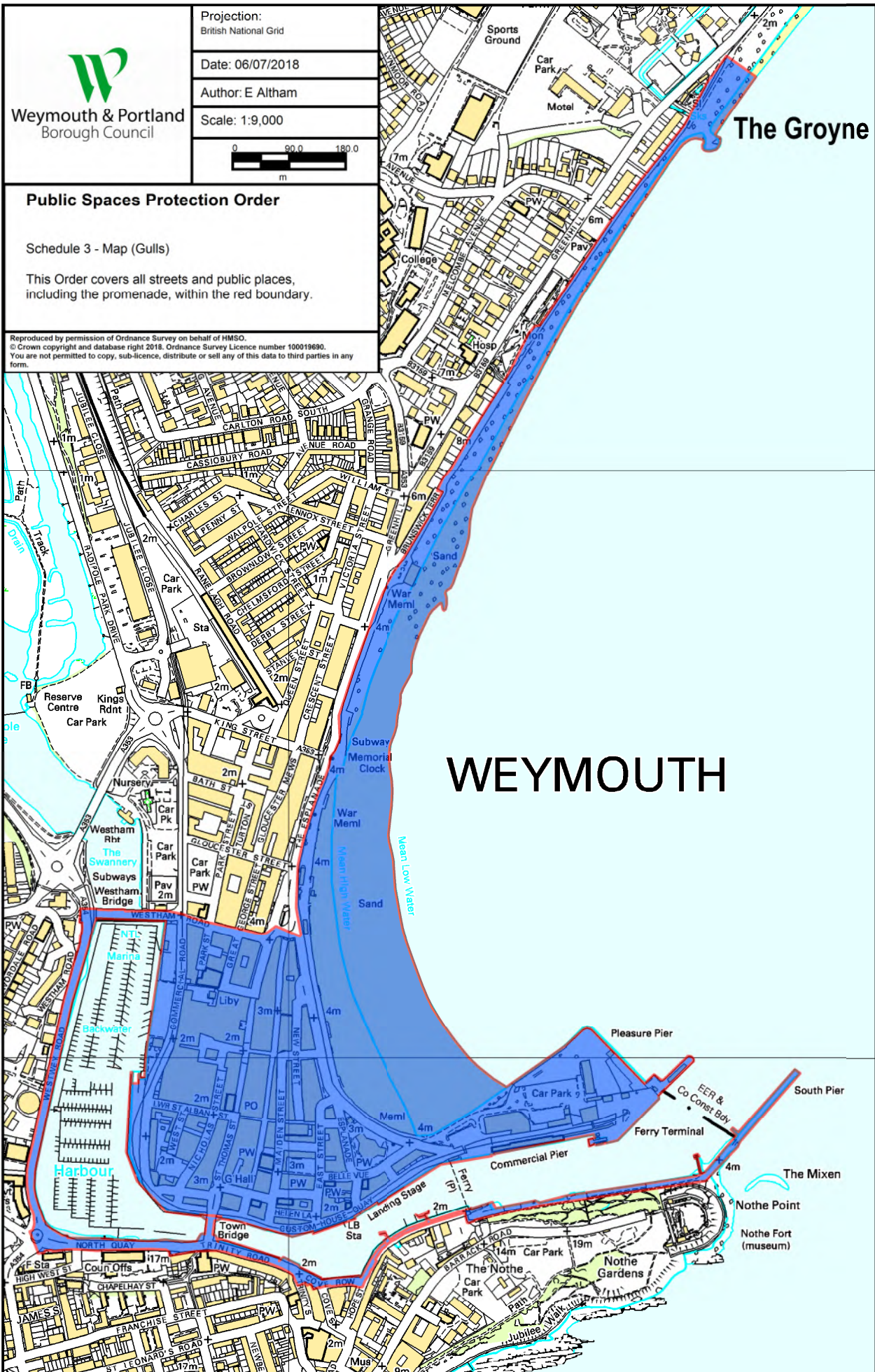

The Groyne

WEYMOUTH

South Pier

The Mixen

Nothe Point

Nothe Fort (museum)



Projection:
British National Grid

Date: 06/07/2018

Author: E Altham

Scale: 1:4,000

Public Spaces Protection Order

Schedule 4 - Map (Begging)

This Order covers all streets and other public places, within the red boundary and shaded in blue.

Reproduced by permission of Ordnance Survey on behalf of HMSO.
© Crown copyright and database right 2018. Ordnance Survey Licence number 100019690.
You are not permitted to copy, sub-licence, distribute or sell any of this data to third parties in any form.

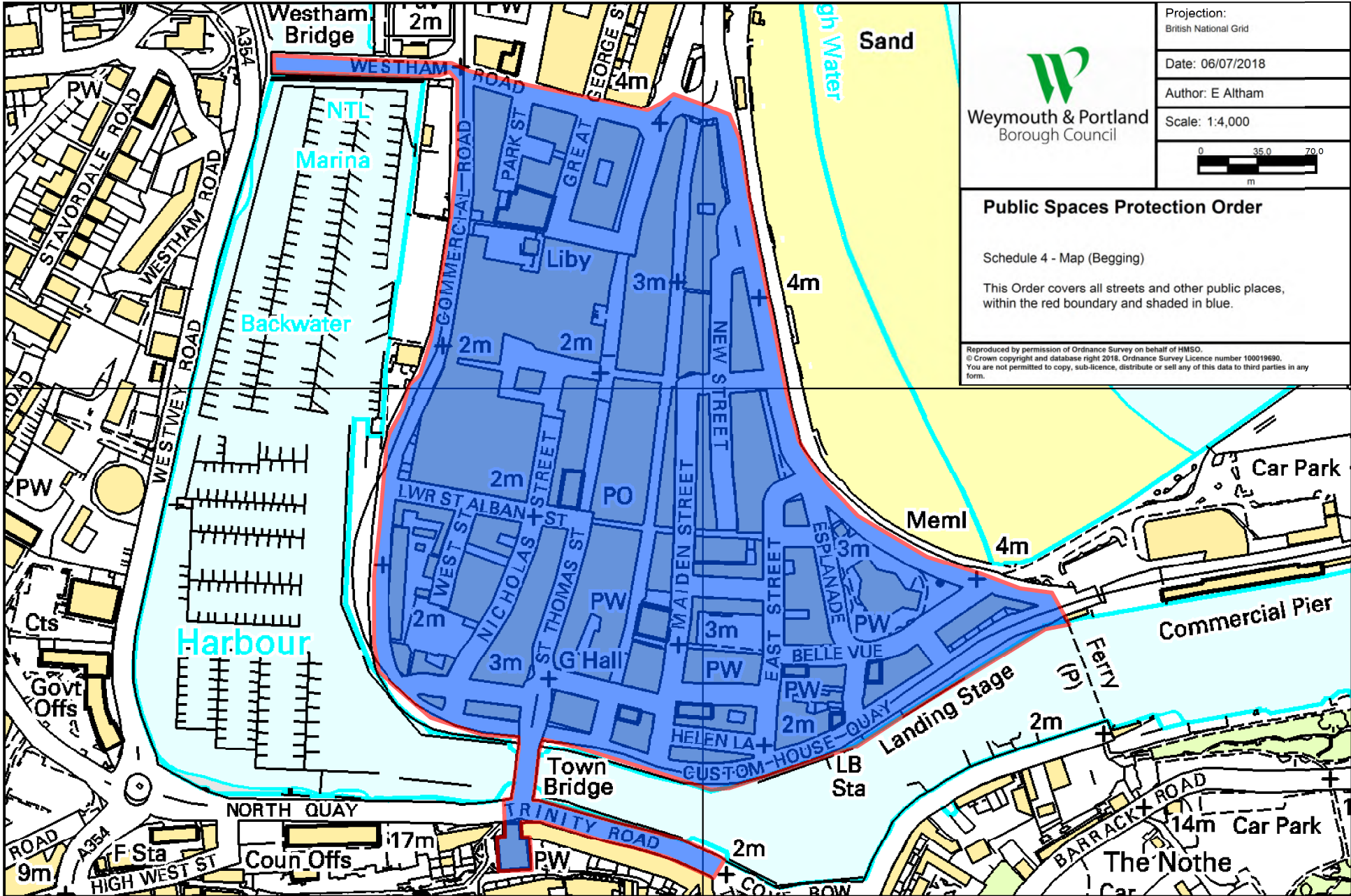



Weymouth & Portland
Borough Council

Projection:
British National Grid

Date: 06/07/2018

Author: E Altham

Scale: 1:8,000

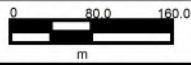

Public Spaces Protection Order

Schedule 5 - Map (Cycling)

This Order covers the promenade, within the red boundary.

Reproduced by permission of Ordnance Survey on behalf of HMSO.
© Crown copyright and database right 2018. Ordnance Survey Licence number 100019690.
You are not permitted to copy, sub-licence, distribute or sell any of this data to third parties in any form.

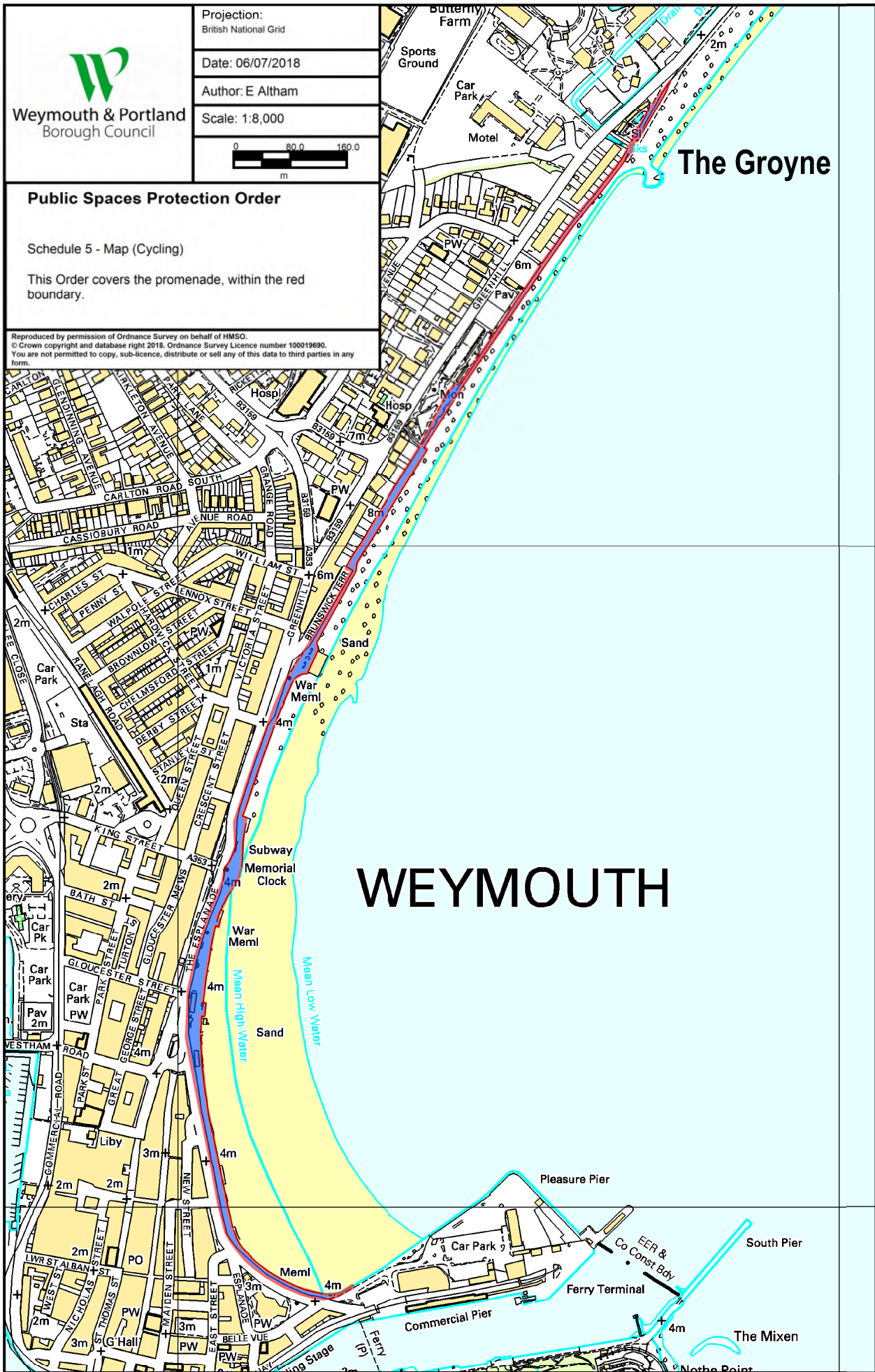

DORSET COUNCIL**Weymouth & Portland Anti-social Behaviour Related Public
Spaces Protection Order 2018****Anti-social Behaviour, Crime and Policing Act 2014
Section 60****Record of Extension**

Pursuant to section 60(2) of the Anti-social Behaviour, Crime and Policing Act 2014, the period that the Dorset Council Weymouth & Portland Anti-social Behaviour Related Public Spaces Protection Order 2018 (“the Order”) has effect was extended from the original date of expiry, 20 August 2021, to 19 August 2022.

The decision to extend the Order was made by the Dorset Council Cabinet on 6 April 2021 and became effective on 15 April 2021.

The Order will now expire on 19 August 2022.

Dated this 17 day of May 2021

Signed:

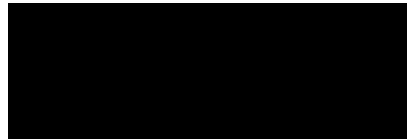

Authorised Signatory